

NOTE: FIELD REMOVE FOAM AND LINER AT CUTBACK

HI RIB INSIDE CLOSURE STRIP W/
1/2" X 3/32" BUTYL TAPE SEALANT
BETWEEN ROOF PANEL AND EAVE
CLOSURE

1/4 - 14 X 7/8 STITCH
TEKS 6" O/C

"EC-02" EAVE CLOSURE

POP RIVETS 12" O/C

"WC-01" PANEL CLIP W/
1/4 - 14 TEK 3 FASTENERS W/O
WASHER AT PANEL JOINT

FASTENING SCHEDULE WILL VARY
DEPENDING ON SPECIFIC APPLICATION

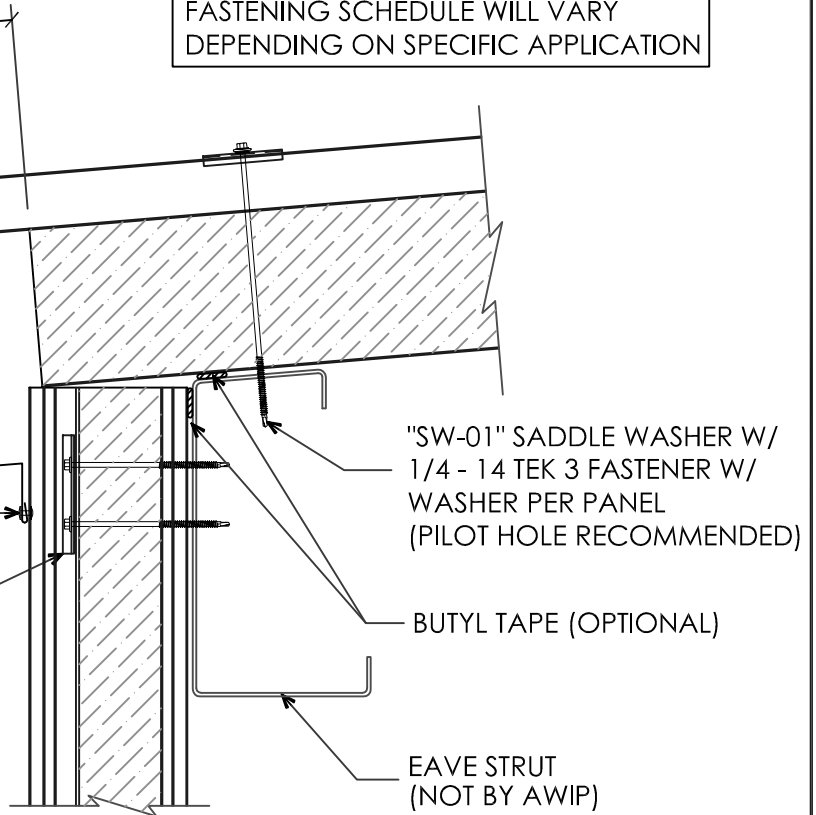

GUTTERLESS EAVE (SECTION VIEW)



929 ALDRIDGE ROAD, VACAVILLE, CA 95688
PHONE: (707) 359-2280 FAX: (707) 359-2286

DETAIL:	GUTTERLESS EAVE	
APPLICATION:	COMMERCIAL & INDUSTRIAL	
DATE: 03/06/07	JOB NO:	XXXXXXXXXX
DRAWN: CLR	SHEET:	1 OF 1