

"SW-01" SADDLE WASHER  
W/ 1/4 - 14 TEK 3 FASTENER  
INTO SUPPORT MEMBER

1/2" X 3/32" BUTYL TAPE  
SEALANT

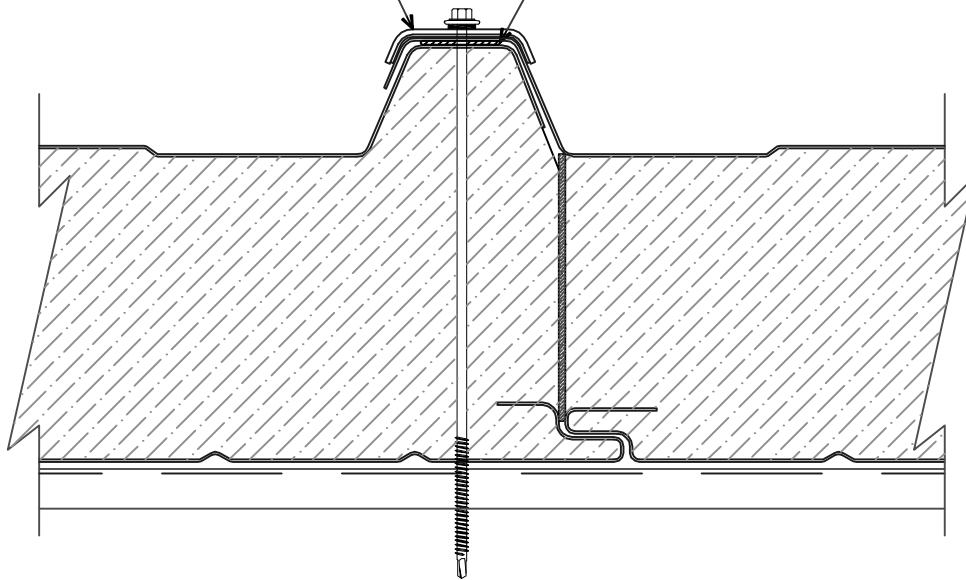

ROOF INSTALLATION DIRECTION

## ROOF PANEL JOINT

(SECTION VIEW)

**A** ALL WEATHER  
INSULATED PANELS

929 ALDRIDGE ROAD, VACAVILLE, CA 95688  
PHONE: (707) 359-2280 FAX: (707) 359-2286

DETAIL: ROOF PANEL JOINT

APPLICATION: COMMERCIAL & INDUSTRIAL

DATE: 03/06/07

JOB NO: XXXXXXXX

DRAWN: CLR

SHEET: 1 OF 1