

FILL GAP CONTINUOUSLY WITH  
FOAMED-IN-PLACE URETHANE  
(NOT BY IMP SUPPLIER)

**NOTE: FIELD REMOVE FOAM & LINER AT CUTBACK.  
LEAVE FOAM INTACT AT TRAPEZOIDAL RIB AND AT  
STANDING SEAM RIB, TYP.**

"GS-02S" GUTTER HANGER  
20" O/C W/ (5) 1/4 - 14 x 7/8"  
STITCH TEKS

"GT-01S" GUTTER TRIM

1/4 - 14 7/8" STITCH TEKS  
6" O/C

"ET-03" EAVE TRIM W/  
STITCH TEK 12" O/C  
(SET IN BUTYL SEALANT)

"BB-01" BIRD BLOCK W/  
1/4 - 14 x 7/8" STITCH TEK 12" O/C

"WC-01" PANEL CLIP W/  
( ) 1/4 - 14 x \_" TEK 3 W/O  
WASHER AT PANEL JOINT

BUTYL SEALANT AT  
VERTICAL JOINT

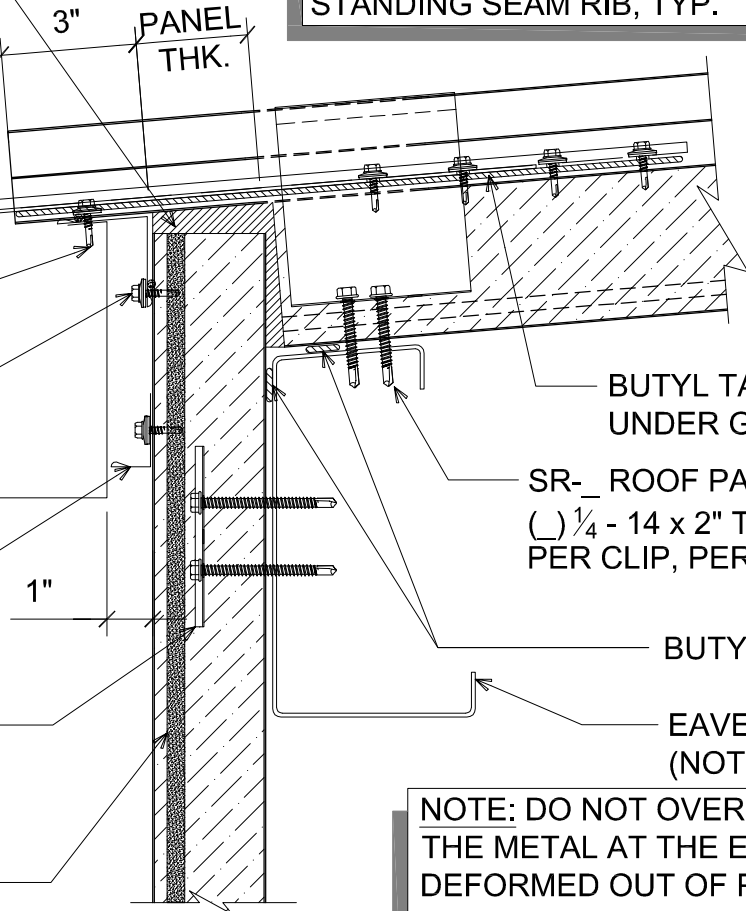

BUTYL TAPE SEALANT STRIP  
UNDER GUTTER STRAP

SR- ROOF PANEL CLIP W/  
( ) 1/4 - 14 x 2" TEK 3 W/O WASHER  
PER CLIP, PER PANEL AT EAVE STRUT

BUTYL TAPE SEALANT

EAVE STRUT  
(NOT BY IMP SUPPLIER)

**NOTE: DO NOT OVER-DRIVE FASTENERS. IF  
THE METAL AT THE EDGE OF THE PANEL IS  
DEFORMED OUT OF PLANE, THE ADJACENT  
PANEL WILL BE DIFFICULT TO ENGAGE AND  
WILL NOT SEAM. AFTER SR CLIP HAS BEEN  
INSTALLED OVER MALE LEG OF STANDING  
SEAM PANEL, PRE-CRIMP, USING (RENTED)  
1/2" HAND CRIMPING TOOL.**

# # EAVE W/ GUTTER

(SECTION VIEW)

DETAIL:	EAVE W GUTTER
APPLICATION:	COLD STORAGE - SR ROOF
DATE:	05/23/16
JOB NO:	N/A
DRAWN:	MMF
SHEET:	1 OF 1

US: (888) 970-2947  
CA: (800) 265-6583 (English)  
CA: (800) 567-2582 (French)  
WWW.AWIPANELS.COM

ALL WEATHER  
INSULATED PANELS

