

Design No. AWIP/FWPA 60-01
ALL WEATHER INSULATED PANELS – 1 HOUR FIRE RATED WALL ASSEMBLY
AWIP FiRe Panel Wall Assembly
Vertical Asymmetric Wall Assembly (Symmetric option: see Item 5)
ASTM E119 and CAN/ULC S101 – 1 Hour Non-load-bearing

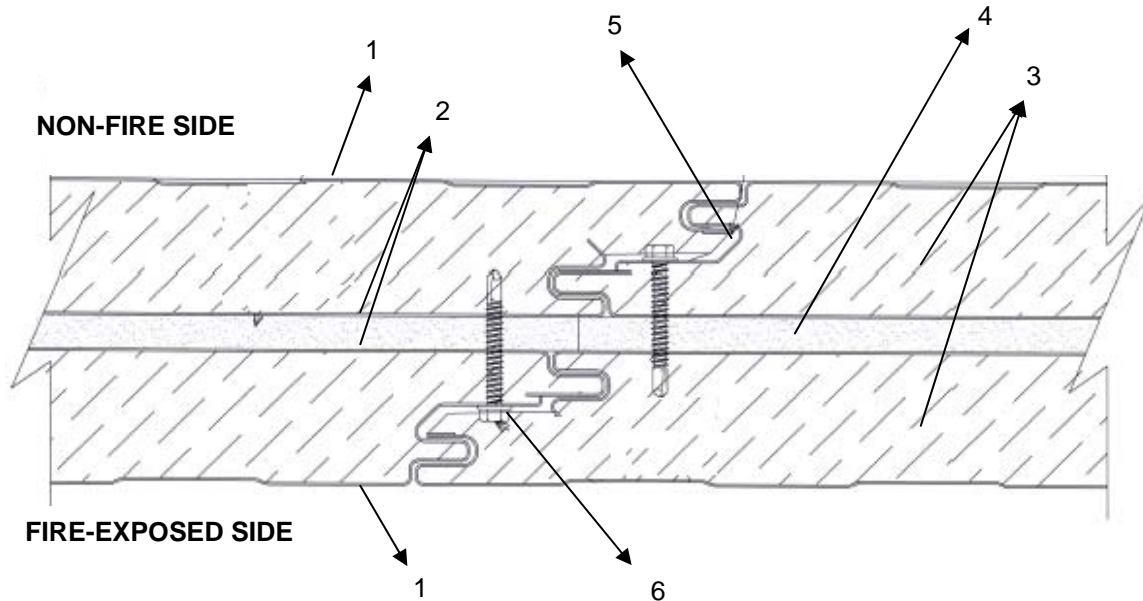

Overall FiRe Panel Thickness	Panel thickness per side	Fastener length (see Item 5)
4.5 in.	2.0 in.	2 in.
5.5 in.	2.5 in.	2.5 in. or 3 in.*
6.5 in.	3.0 in.	3 in.

*Depending on the thickness of that side's panel

1. **External Steel Facing:** The facing skins of the AWIP FiRe Panel are composed of min. 26 GA galvanized steel, ASTM A653, Grade 33 G90 (Top Coating: Imperial White Spectra 20 S14721, Bottom Coating: DC Epoxy Primer). This steel facing may be embossed or finished with different patterns and textures, including (but not limited to) Mesa, Double Mesa, Striated, Flat/Smooth, and Adobe texture.
2. **Internal Steel Skins:** The center skin is composed of 29 GA coated steel (55% Aluminum-Zinc Alloy coated with AZ50) ASTM A792, CS Type B
3. **Insulation:** The core consists of a two-part Polyisocyanurate foam of proprietary formulation with a density of 2.15 pcf.
4. **Gypsum Board:** One layer of 1/2 in. thick Pabco Gypsum Type XXX Gypsum board.
5. **Sealant:** 1/2 in. bead of Rutland Clear RTV High Heat Silicon applied to the Non-Fire side of the panel only.
OPTIONAL: For symmetrical wall assembly, apply 1/2 in. bead of sealant on both Non-fire and Fire-exposed sides of the wall assembly.
6. **Joint Fasteners:** 1/4 in. - 14 HWH Self Driller Zinc Plated Screws. Alternatively, #14-13 TEK 3 fasteners with low profile heads may be used. Fasteners may be 2 in. to 3 in. long depending on panel thickness Joint fasteners are located 6 in. from top and bottom, and 12 in. on centre.
7. **Steel C-Channel (Not shown):** The AWIP FiRe Panels are held in place at the top, bottom and sides by 26 GA steel C-Channel with 1-1/2 in. legs. The panels are fastened into C-channels using 1/4 in. – 14 X 5 in. Tek

3 screws penetrating the full wall thickness, with 5 fasteners per 10 ft. span.

8. Intermediate Supports (Optional, not required for fire resistance, and not shown): Where panel walls require additional support for project specific reasons, intermediate steel supports may be installed, in accordance with manufacturer's instructions, on the panel span between the end panel support connections, using #14 self-drilling or self-tapping screws having sufficient length to extend from the hidden clip placement point under the exterior formed edge of the panel, completely into the support steel on the opposite side or #10 FabLok rivets. Spacing is determined by project requirements.

9. Exterior Cladding and Accessories (Optional, not shown): Any single layered noncombustible cladding, of any thickness and

profile, may be fastened to steel hat channels that are fastened to either face of the wall assembly along the joints. The fastener type and spacing are job specific parameters and will vary depending on the wind load requirement.



8431 Murphy Drive
Middleton, WI 53562

Telephone: +1 608 836 4400
Facsimile: +1 608 831 9279
www.intertek.com

June 9, 2014

Brian Ng
Technical Specialist

All Weather Insulated Panels | A Vicwest Company
929 Aldridge Road, Vacaville, CA 95688
T: (707) 359-2280
bng@awipanel.com

Subject: Intertek and UL

Dear Mr. Ng:

This is to confirm that Intertek (using the WHI mark) is accredited and performs all testing, certification and inspection services to ANSI/ISO/IEC standards, the same standards to which UL is accredited. We are accredited to perform testing, certification and inspections to the same standards that UL is accredited.

Specifically, Intertek is accredited to the following:

- ANSI/ISO/IEC Standard 17025:2005, General criteria for the competence of testing and calibration laboratories;
- ISO/IEC Standard 17020, General criteria for the operation of various types of bodies performing inspection;
- ISO/IEC Guide 65 (1996), General requirements for bodies operating product certification systems

Intertek is accredited to each of these standards by International Accreditation Services (IAS), under the Certificate Numbers TL-271, AA-690, and PCA-101. Also Intertek is accredited to ISO/IEC Guide 65 with Standards Council of Canada (SCC). In addition Intertek is a Nationally Recognized Laboratory under the OSHA criteria for Nationally Recognized Test Laboratories.

The inspections are conducted at the manufacturing plants a minimum of once every quarter for a total of 4 inspections per year. This requirement is not only part of Intertek's Standard Operating Procedures but is required for our continued accreditation with Standards Council of Canada (SCC).

Please contact us if you require additional information regarding Intertek and the WHI mark.

Sincerely,

Inspections Manager/Engineer
Intertek

ATTACHMENT



The Proof is in the Checklist

Intertek's dedicated level of quality service and cutting-edge practices place us far ahead of the competition.



Valued Quality. Delivered.



• Nationally Recognized Testing Laboratory	✓	✓	✓
• Accepted by ALL major retailers	✓	✓	✓
• Tests to nationally accepted safety standards	✓	✓	✓
• Recognized by AHJs	✓	✓	✓
• Fast turnaround	✓	✓	-
• Committed to getting your product to market faster	✓	✓	-
• Client focused project management	✓	✓	-
• Flexible solutions based on your testing needs	✓	✓	-
• Collaborative testing environment	✓	✓	-
• Concurrent product safety & performance testing	✓	✓	-

About Intertek

Intertek operates in more than 100 countries with over 30,000 employees.

To learn more about Intertek's Warnock Hersey (WH) Mark and our broad range of Building Products testing and certification services, visit us online at www.intertek.com/marks/WH, email icenter@intertek.com or call 1-800-WORLDFAB.