

NOTE: REFER TO JOINERY STITCH FASTENING DETAIL ON SHEET \_\_.

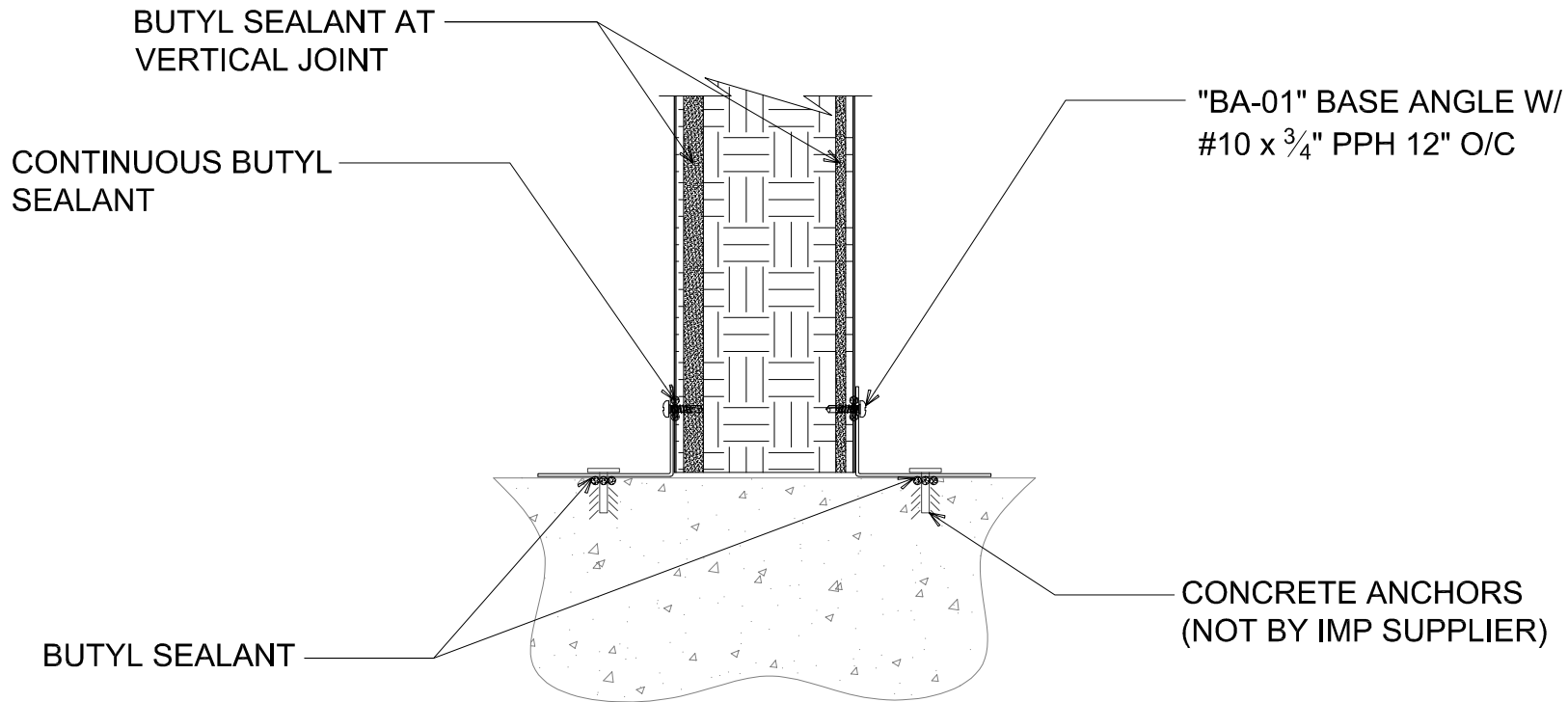

# # PARTITION BASE CONDITION - FLUSH

(SECTION VIEW)

DETAIL:

## BASE CONDITION - FLUSH

APPLICATION:

PARTITION FIRE WALL, AMBIENT

AWIP DETAIL NUMBER:

MVW-AA-BC-001

929 ALDRIDGE ROAD  
VACAVILLE, CA 95688  
TEL: (707) 359-2280  
FAX: (707) 359-2286  
WWW.AWIPANELS.COM

ALL WEATHER  
INSULATED PANELS



DATE: 04/02/19

DRAWN BY: MMF

SHEET:

1 OF 1