

#14 - 13 x 1½" TRUSS HEAD TEK FASTENERS 12" O/C AT JOINERY (ALIGN WITH THROUGH FASTENERS AT THE RAKE)

ONEDEK™ THERMOPLASTIC ROOF MEMBRANE (SEE "ONEDEK™ ROOFING MEMBRANE" FOR ATTACHMENT OPTIONS)

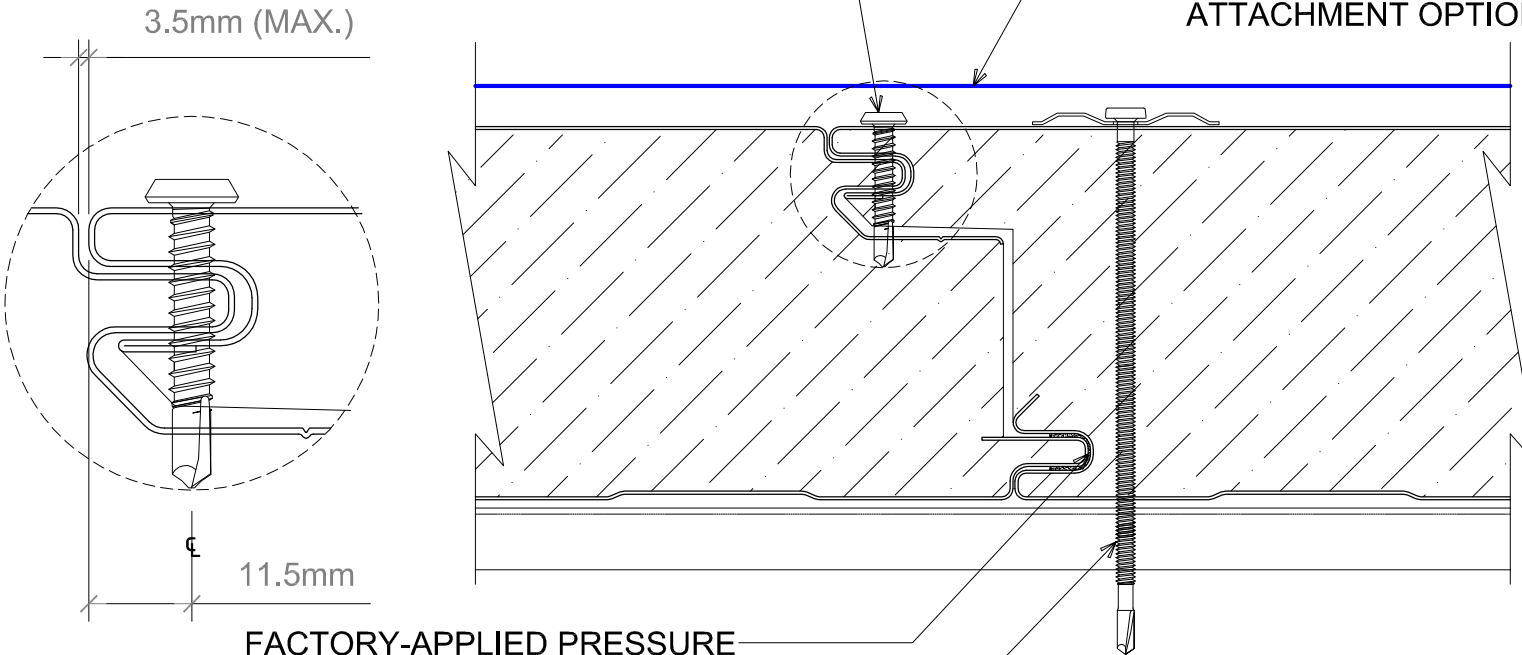

FACTORY-APPLIED PRESSURE DIFFERENTIAL BUTYL SEALANT (NON-SKINNING)

#12 - 24 x ½" TRUFAST PURLIN FASTENERS W/ "RP-01" ROOF DECK PLATE

NOTE: FACTORY SEALANT IS APPLIED PRIOR TO THE INLINE CUT OFF SAW AND IS NECESSARY TO LEAVE A 3" TO 5" UNCAULKED SECTION AT PANEL ENDS TO AVOID GETTING CAULKING ON SAW BLADE. THESE AREAS MUST BE FILLED IN THE FIELD.

RD1 PANEL JOINT (COLD-STORAGE)

(SECTION VIEW)

DETAIL: RD1 PANEL JOINT (COLD-STORAGE)

APPLICATION:
RD1 ROOF DECK, COLD-STORAGE
AWIP DETAIL NUMBER:
RDR-ACS-PJ-001

SHEET:
DATE: 01/22/20
DRAWN BY: MMF
1 OF 1

929 ALDRIDGE ROAD
VACAVILLE, CA 95688
TEL: (707) 359-2280
FAX: (707) 359-2286
WWW.AWIPANELS.COM

