

"WC-01" PANEL CLIP W/
() 1/4 - 14 x _ TEK 3 W/O
WASHER AT PANEL JOINT

SECONDARY FRAMING
(NOT BY ONEDEK™
SUPPLIER)

FILL VOID WITH
COMPRESSIBLE INSULATION
(NOT BY ONEDEK™ SUPPLIER)

CONTINUOUS THERMAL
CUT FOR COLD STORAGE
APPLICATIONS

NOTE: BUTYL SEALANT AT WALL
JOINERY NOT SHOWN FOR CLARITY.

#12 - 24 x _ " TRUFAST PURLIN
FASTENERS W/ "RP-01" ROOF DECK
PLATE _ " O/C

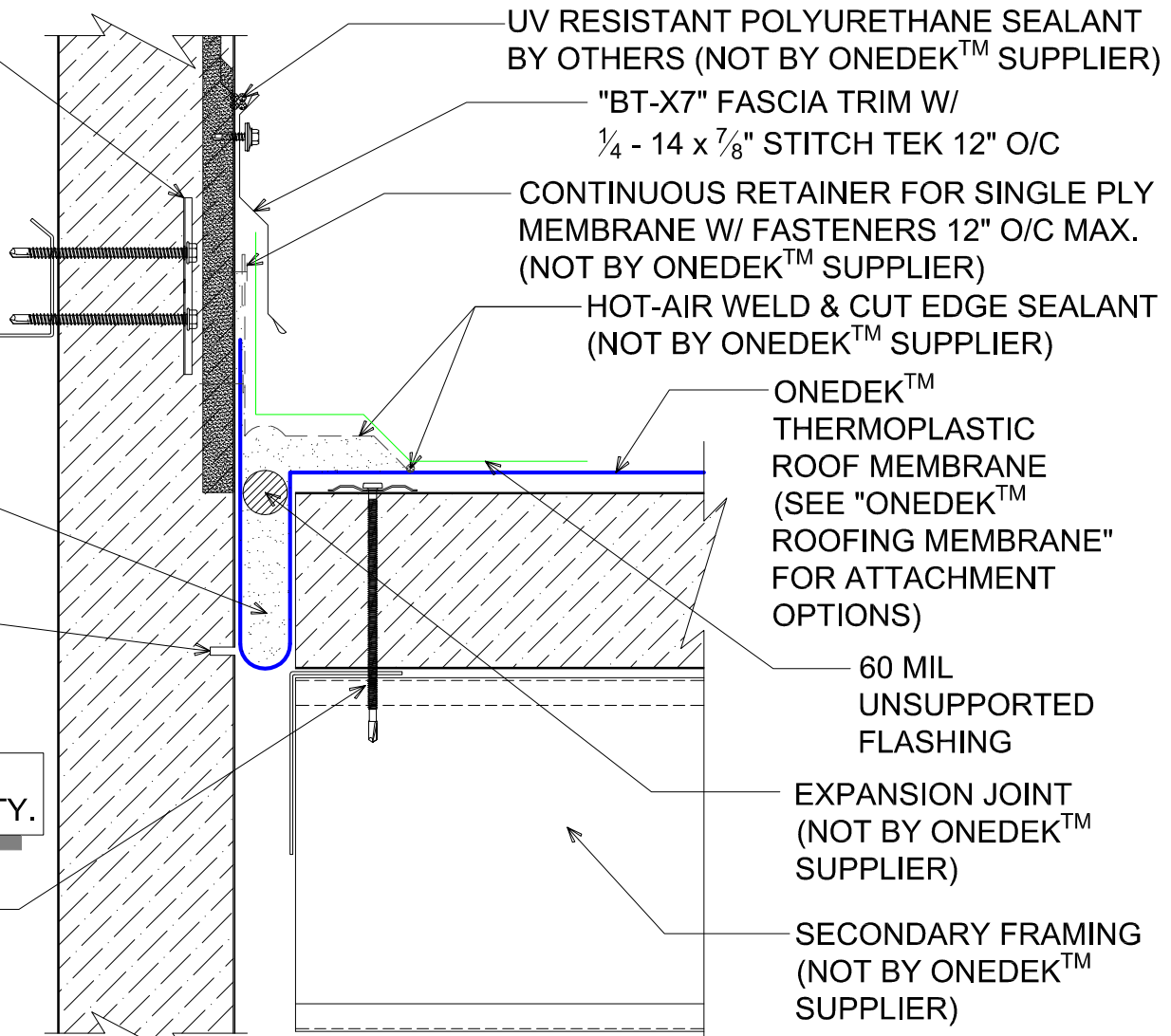

BASE FLASHING AT ROOF-TO-WALL EXPANSION JOINT (RAKE)

(SECTION VIEW)

DETAIL: **ROOF-TO-WALL EXPANSION JOINT (RAKE)**

929 ALDRIDGE ROAD
VACAVILLE, CA 95688
TEL: (707) 359-2280
FAX: (707) 359-2286
WWW.AWIPANELS.COM

ALL WEATHER
INSULATED PANELS
AWIP

APPLICATION:
RD1 ROOF DECK, COMMERCIAL & INDUSTRIAL, COLD-STORAGE
AWIP DETAIL NUMBER:
RDR-CJCS-EJ-003

DATE:
06/09/21
DRAWN BY:
MMF

SHEET:
1
OF
1