

"BC-02" 20 GA CHANNEL CAP W/
#14 - 13 x 1½" TRUSS HEAD TEK
FASTENERS 12" O/C. W/ BUTYL
SEALANT AT FLANGES (MARRY
TO VERTICAL SEALANT)

NOTE: BUTYL SEALANT AT WALL
JOINERY NOT SHOWN FOR CLARITY.
ENSURE ALL SEALANTS MARRY TO
CREATE A THERMAL ENVELOPE.

NOTE: REFER TO DETAIL _E FOR
EDGE METAL ASSEMBLY
INFORMATION.

FILL VOID WITH ONE-PART
EXPANDING FOAM SEALANT

CONTINUOUS THERMAL
CUT FOR COLD STORAGE
APPLICATIONS

"WC-01" PANEL CLIP W/
() ¼ - 14 x _ TEK 3 FASTENERS
W/O WASHER AT PANEL JOINT

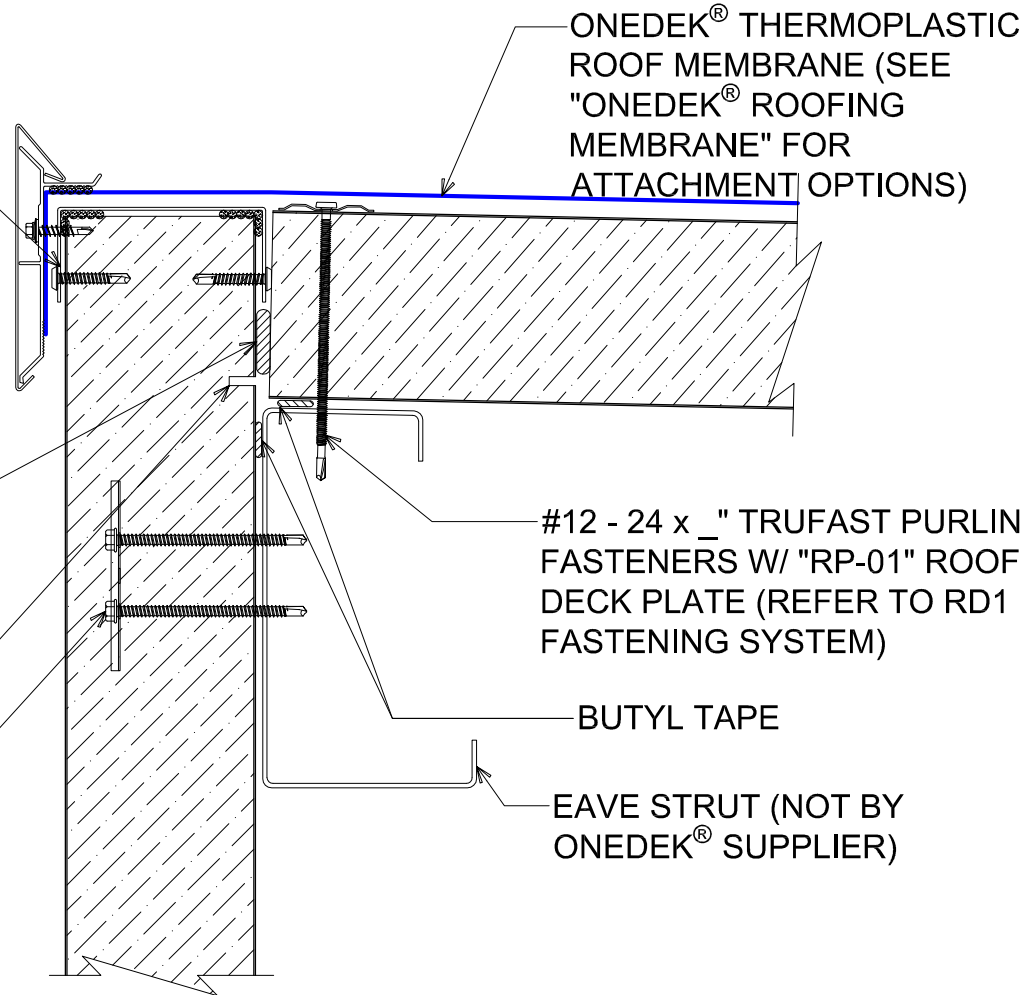

PERIMETER EDGE METAL (HIGH EAVE)

(SECTION VIEW)

DETAIL: PERIMETER EDGE METAL (HIGH EAVE)

929 ALDRIDGE ROAD
VACAVILLE, CA 95688
TEL: (707) 359-2280
FAX: (707) 359-2286
WWW.AWIPANELS.COM

All Weather
Insulated Panels



DATE: 08/09/22
DRAWN BY: MMF

SHEET: 1 OF 1

APPLICATION: RD1 ROOF DECK, COMMERCIAL & INDUSTRIAL, COLD-STORAGE
AWIP DETAIL NUMBER: RDR-CJCS-HE-001

"BC-02" 20 GA CHANNEL CAP W/
#14 - 13 x 1½" TRUSS HEAD TEK
FASTENERS 12" O/C. W/ BUTYL
SEALANT AT FLANGES (MARRY
TO VERTICAL SEALANT)

#12-14 x 1¼" HWH/BD TEKS 2
STAINLESS STEEL FASTENERS
12" O/C

AF-55 FASCIA COVER (12'-0"
LENGTHS)

ANCHOR BAR EXTRUDED

BUTYL SEALANT

ONEDEK® THERMOPLASTIC
ROOF MEMBRANE (SEE
"ONEDEK® ROOFING
MEMBRANE" FOR
ATTACHMENT OPTIONS)

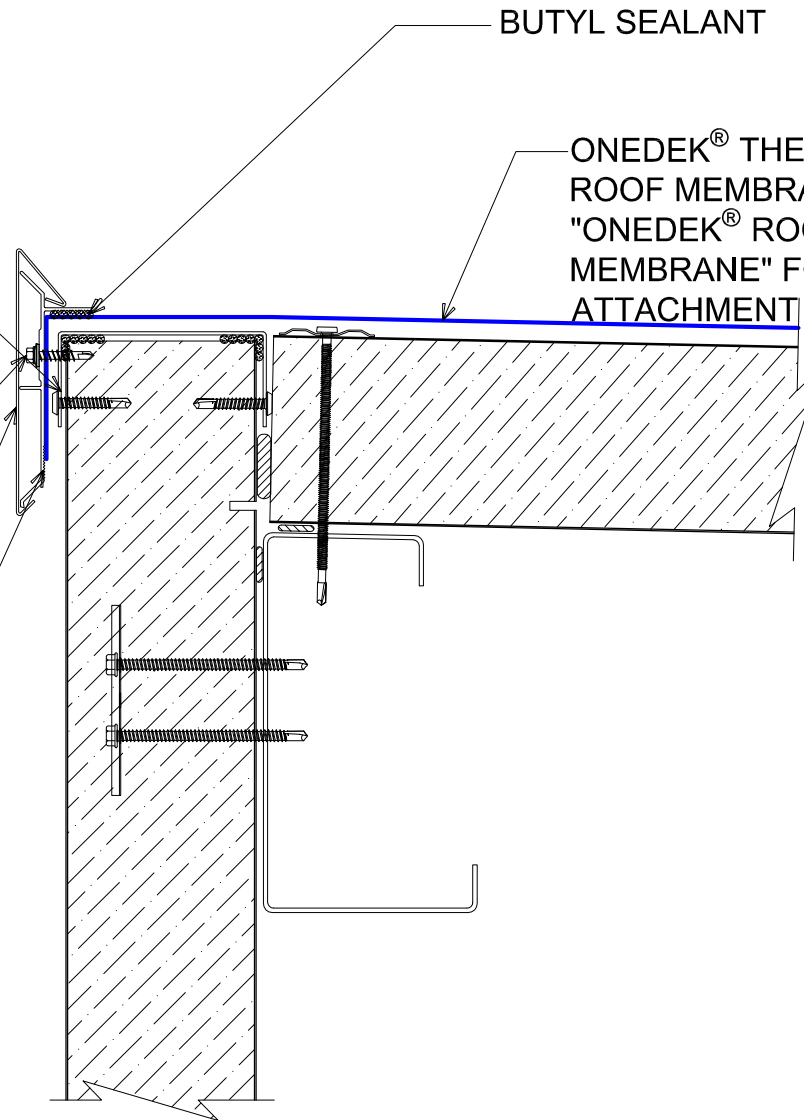

#E PERIMETER EDGE METAL (HIGH EAVE)

(SECTION VIEW)

DETAIL:

PERIMETER EDGE METAL (HIGH EAVE), AF-55

APPLICATION:
RD1 ROOF DECK, COMMERCIAL & INDUSTRIAL, COLD-STORAGE
AWIP DETAIL NUMBER:
RDR-CICS-HE-001

DATE: 08/09/22
DRAWN BY: MMF

SHEET: 1 OF 1

929 ALDRIDGE ROAD
VACAVILLE, CA 95688
TEL: (707) 359-2280
FAX: (707) 359-2286
WWW.AWIPANELS.COM



"BC-02" 20 GA CHANNEL CAP W/
 #14 - 13 x 1½" TRUSS HEAD TEK
 FASTENERS 12" O/C. W/ BUTYL
 SEALANT AT FLANGES (MARRY
 TO VERTICAL SEALANT)

#12-14 x 1¼" HWH/BD TEKS 2
 STAINLESS STEEL FASTENERS
 12" O/C

AF-70 FASCIA COVER (12'-0"
 LENGTHS)

ANCHOR BAR EXTRUDED

BUTYL SEALANT

ONEDEK® THERMOPLASTIC
 ROOF MEMBRANE (SEE
 "ONEDEK® ROOFING
 MEMBRANE" FOR
 ATTACHMENT OPTIONS)

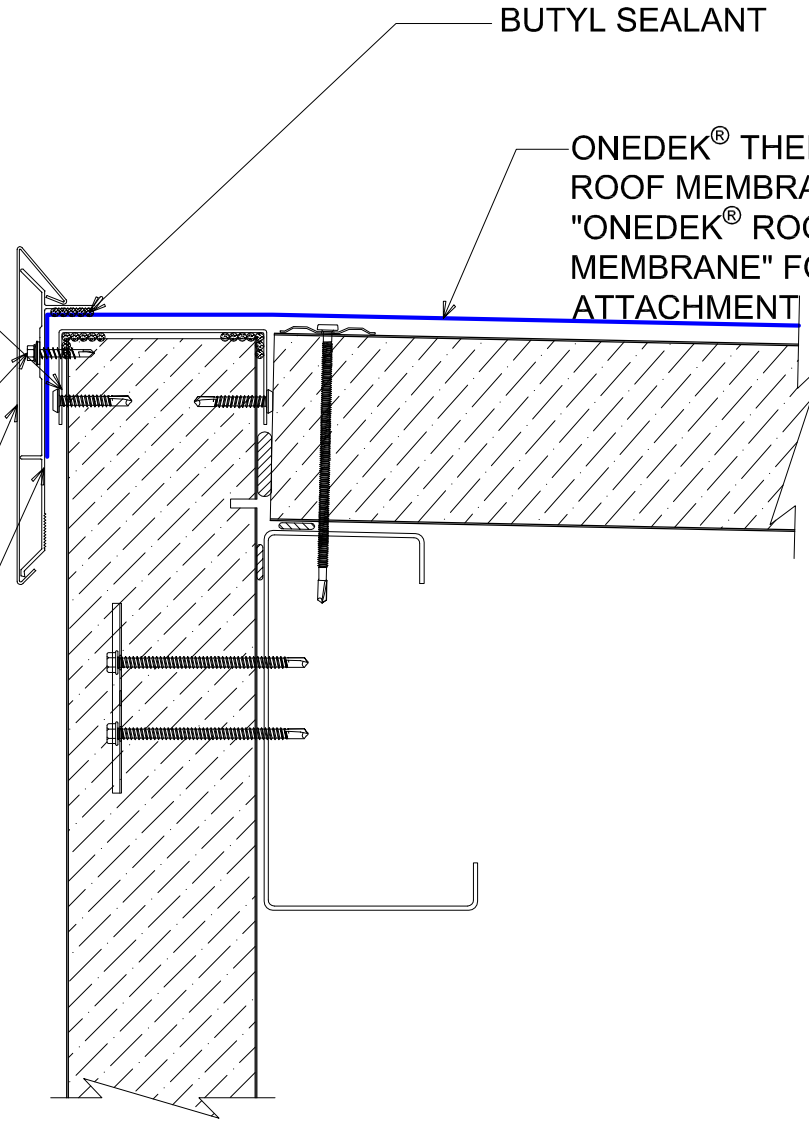

#E PERIMETER EDGE METAL (HIGH EAVE)

(SECTION VIEW)

DETAIL:

PERIMETER EDGE METAL (HIGH EAVE), AF-70

APPLICATION:
 RD1 ROOF DECK, COMMERCIAL & INDUSTRIAL, COLD-STORAGE
 AWIP DETAIL NUMBER:
 RDR-CICS-HE-001

DATE: 08/09/22
 DRAWN BY: MMF

SHEET: 1 OF 1

929 ALDRIDGE ROAD
 VACAVILLE, CA 95688
 TEL: (707) 359-2280
 FAX: (707) 359-2286
 WWW.AWIPANELS.COM

