

"RF-03" ROOF FASCIA W/
#14 - 13 x 1½" TRUSS HEAD
TEK FASTENERS 12" O/C

"BC-02" 20 GA CHANNEL CAP W/
#14 - 13 x 1½" TRUSS HEAD TEK
FASTENERS 12" O/C. W/ BUTYL
SEALANT AT FLANGES (MARRY
TO VERTICAL SEALANT)

**NOTE: BUTYL SEALANT AT WALL
JOINERY NOT SHOWN FOR CLARITY.
ENSURE ALL SEALANTS MARRY TO
CREATE A THERMAL ENVELOPE.**

CONTINUOUS RETAINER FOR SINGLE
PLY MEMBRANE W/ FASTENERS 12" O/C
MAX. (NOT BY ONEDEK™ SUPPLIER)

FILL VOID WITH ONE-PART
EXPANDING FOAM SEALANT
POP RIVET 12" O/C

CONTINUOUS THERMAL
CUT FOR COLD STORAGE
APPLICATIONS

"WC-01" PANEL CLIP W/
() ¼ - 14 x _ TEK 3 FASTENERS
W/O WASHER AT PANEL JOINT

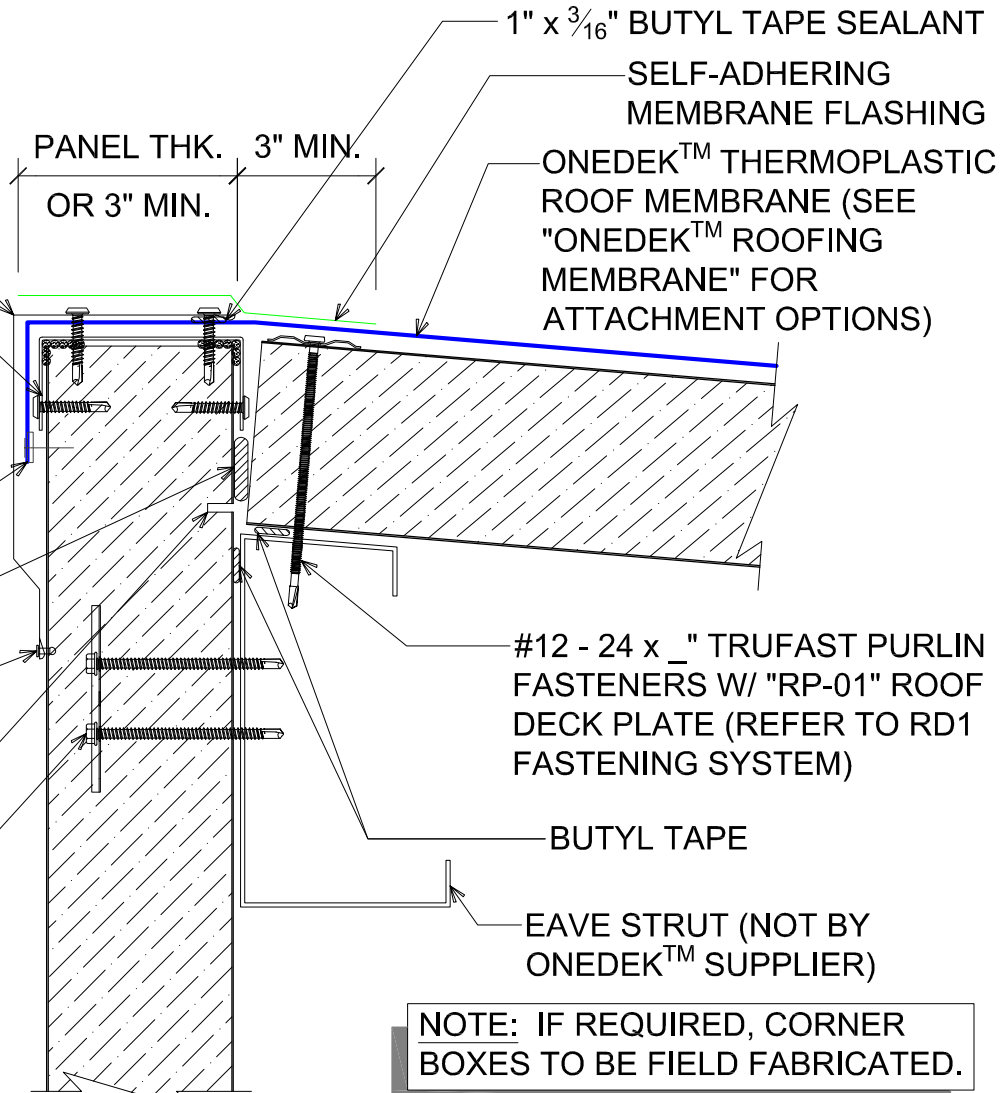

**NOTE: IF REQUIRED, CORNER
BOXES TO BE FIELD FABRICATED.**

PERIMETER EDGE METAL W/ MEMBRANE COATING (HIGH EAVE)

(SECTION VIEW)

DETAIL: PERIMETER EDGE METAL (HIGH EAVE)

929 ALDRIDGE ROAD
VACAVILLE, CA 95688
TEL: (707) 359-2280
FAX: (707) 359-2286
WWW.AWIPANELS.COM

ALL WEATHER
INSULATED PANELS



DATE: 06/18/19
DRAWN BY: MMF

APPLICATION: RD1 ROOF DECK, COMMERCIAL & INDUSTRIAL, COLD-STORAGE
AWIP DETAIL NUMBER: RDR-CJCS-HE-001

SHEET: 1 OF 1