

"BC-02" 20 GA CHANNEL CAP W/  
 #14 - 13 x 1½" TRUSS HEAD TEK  
 FASTENERS 12" O/C. W/ BUTYL  
 SEALANT AT FLANGES (MARRY TO  
 VERTICAL SEALANT)

NOTE: BUTYL SEALANT AT WALL  
 JOINERY NOT SHOWN FOR CLARITY.  
 ENSURE ALL SEALANTS MARRY TO  
 CREATE A THERMAL ENVELOPE.

CONTINUOUS RETAINER FOR  
 SINGLE PLY MEMBRANE W/  
 FASTENERS 12" O/C MAX.  
 (NOT BY ONEDEK™ SUPPLIER)

"PT-X1" PARAPET CAP TRIM  
 W/ ¼ - 14 x 7/8" STITCH TEKS 12" O/C

FILL VOID WITH ONE-PART  
 EXPANDING FOAM SEALANT

CONTINUOUS THERMAL  
 CUT FOR COLD STORAGE  
 APPLICATIONS

"WC-01" PANEL CLIP W/  
 ( ) ¼ - 14 x \_ TEK 3 FASTENERS  
 W/O WASHER AT PANEL JOINT

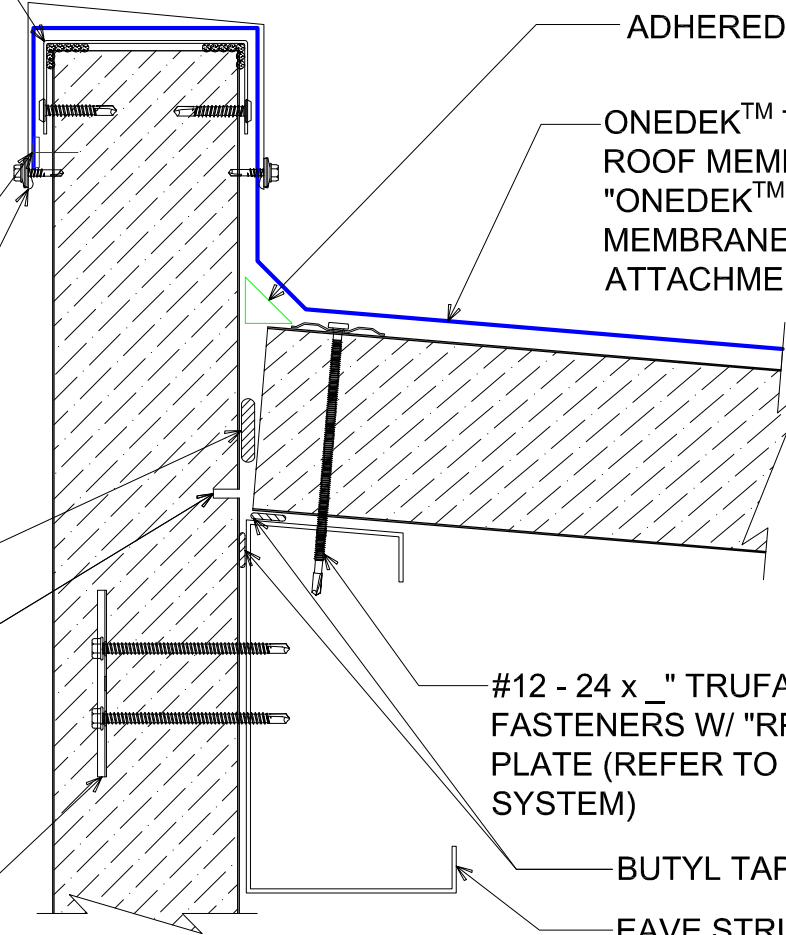

ADHERED CANT STRIP

ONEDEK™ THERMOPLASTIC  
 ROOF MEMBRANE (SEE  
 "ONEDEK™ ROOFING  
 MEMBRANE" FOR  
 ATTACHMENT OPTIONS)

#12 - 24 x \_ TRUFAST PURLIN  
 FASTENERS W/ "RP-01" ROOF DECK  
 PLATE (REFER TO RD1 FASTENING  
 SYSTEM)

BUTYL TAPE

EAVE STRUT (NOT BY  
 ONEDEK™ SUPPLIER)

# # BASE FLASHING AT PARAPET W/ METAL COPING (HIGH EAVE)

(SECTION VIEW)

DETAIL:

## PARAPET W/ METAL COPING (HIGH EAVE)

929 ALDRIDGE ROAD  
 VACAVILLE, CA 95688  
 TEL: (707) 359-2280  
 FAX: (707) 359-2286  
 WWW.AWIPANELS.COM

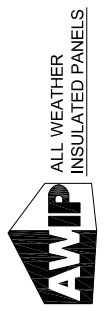

APPLICATION:  
 RD1 ROOF DECK, COMMERCIAL & INDUSTRIAL, COLD-STORAGE  
 AWIP DETAIL NUMBER:  
 RDR-CJCS-HEW-001

DATE:  
 06/18/19  
 DRAWN BY:  
 IMF

SHEET:  
 1  
 OF  
 1