

"WC-01" PANEL CLIP W/
(\square) $\frac{1}{4}$ - 14 x \square TEK 3 W/O
WASHER AT PANEL JOINT

SECONDARY FRAMING
(NOT BY ONEDEK™
SUPPLIER)

FILL VOID WITH
ONE-PART EXPANDING
FOAM SEALANT

CONTINUOUS THERMAL
CUT FOR COLD STORAGE
APPLICATIONS

#12 - 24 x \square TRUFAST PURLIN
FASTENERS W/ "RP-01" ROOF DECK
PLATE (REFER TO RD1 FASTENING
SYSTEM)

UV RESISTANT POLYURETHANE SEALANT
BY OTHERS (NOT BY ONEDEK™ SUPPLIER)

"BT-07" FASCIA TRIM W/
 $\frac{1}{4}$ - 14 x $\frac{7}{8}$ " STITCH TEK 12" O/C

CONTINUOUS RETAINER FOR SINGLE PLY
MEMBRANE W/ FASTENERS 12" O/C MAX.
(NOT BY ONEDEK™ SUPPLIER)

ADHERED CANT STRIP

ONEDEK™ THERMOPLASTIC
ROOF MEMBRANE (SEE
"ONEDEK™ ROOFING MEMBRANE"
FOR ATTACHMENT OPTIONS)

SECONDARY FRAMING
(NOT BY ONEDEK™ SUPPLIER)

NOTE: BUTYL SEALANT AT WALL
JOINERY NOT SHOWN FOR CLARITY.

BASE FLASHING W/ SURFACE-MOUNTED COUNTERFLASHING (HIGH EAVE)

(SECTION VIEW)

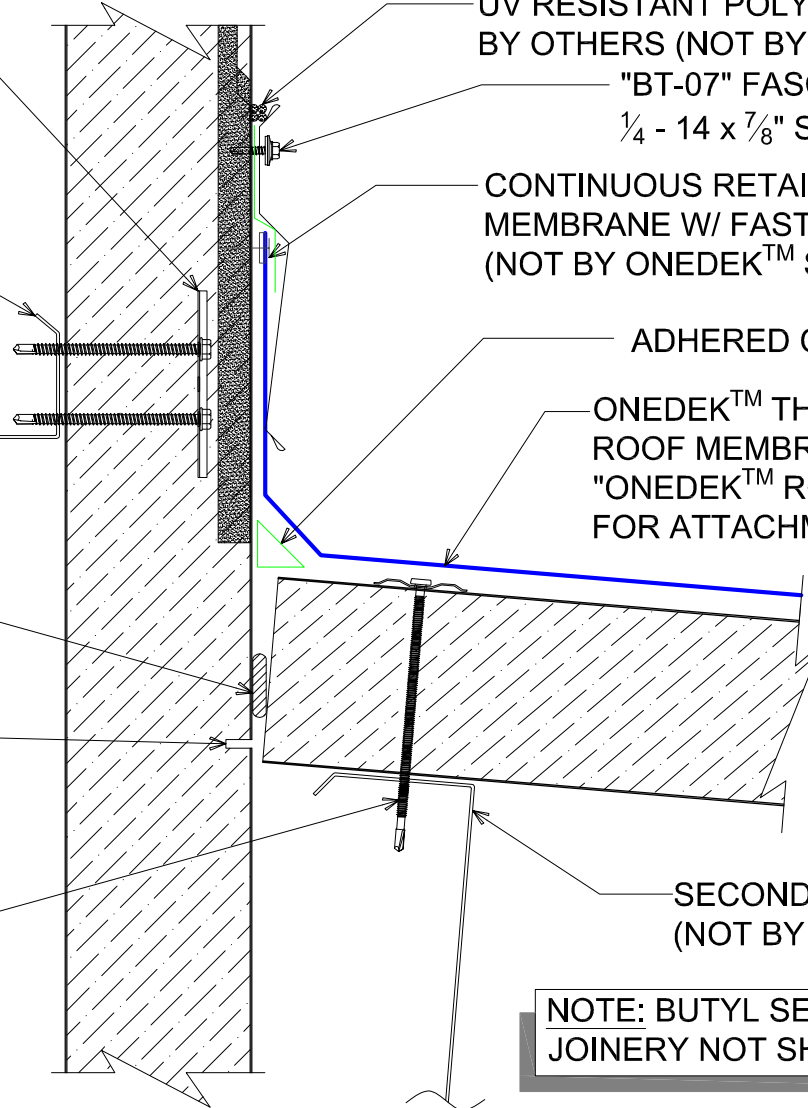

DETAIL:

SURFACE-MOUNTED COUNTERFLASHING (HIGH EAVE)

APPLICATION:
RD1 ROOF DECK, COMMERCIAL & INDUSTRIAL, COLD-STORAGE
AWIP DETAIL NUMBER:
RDR-CICS-HEW-002

DATE:
06/18/19

DRAWN BY:
MMF

SHEET:
1

OF
1

929 ALDRIDGE ROAD
VACAVILLE, CA 95688
TEL: (707) 359-2280
FAX: (707) 359-2286
WWW.AWIPANELS.COM

