

FIELD-CUT
THERMAL BREAK

ONE-PART EXPANDING
FOAM SEALANT (NOT BY
IMP SUPPLIER)

SECONDARY FRAMING
(NOT BY IMP SUPPLIER)

"OC-02 " OUTSIDE CORNER
W/ 10. x 0.75" PPH DP3 12" O/C
(SET TRIM IN BUTYL SEALANT)

() 1/4 - 14 x _ HWH DP3 W/
WASHER, PER PANEL AT
EACH SECONDARY SUPPORT

NOTE: FIELD CUT STARTING PANEL
AND ENDING PANEL AS REQUIRED
AT CORNER TRANSITION.

"IC-05" INSIDE CORNER W/
POP RIVETS 12" O/C
(SET TRIM IN BUTYL SEALANT)

PEEL & STICK BITUMEN
MEMBRANE

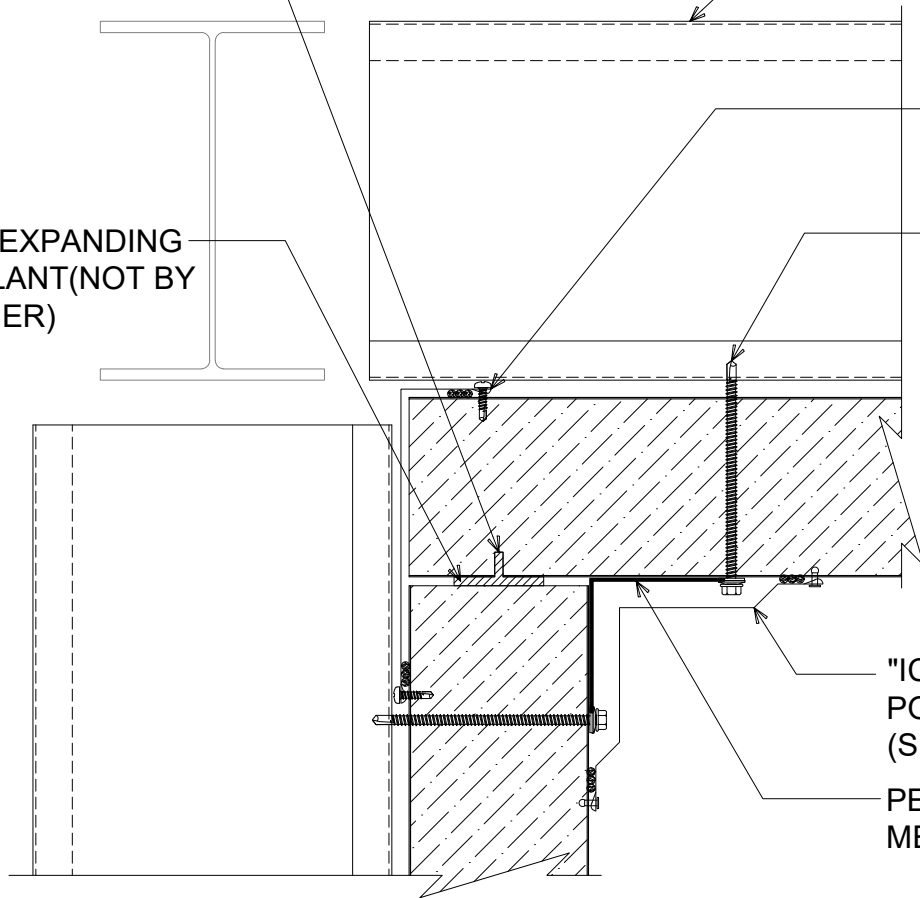

CORNER TRSN - SCULPTED INSIDE
(FREEZER)
(PLAN VIEW)

DETAIL:

CORNER TRANSITION - SCULPTED INSIDE

APPLICATION:
VERTICAL WALL, COLD-STORAGE
AWIP DETAIL NUMBER:
AWW-ACS-CT-008

DATE:
10/04/23
DRAWN BY:
MMF

SHEET:
1 OF 1

929 ALDRIDGE ROAD
VACAVILLE, CA 95688
TEL: (707) 359-2280
FAX: (707) 359-2286
WWW.AWIPANELS.COM

