

NOTE: FASTENING SCHEDULE  
MAY VARY DEPENDING ON  
SPECIFIC APPLICATION.

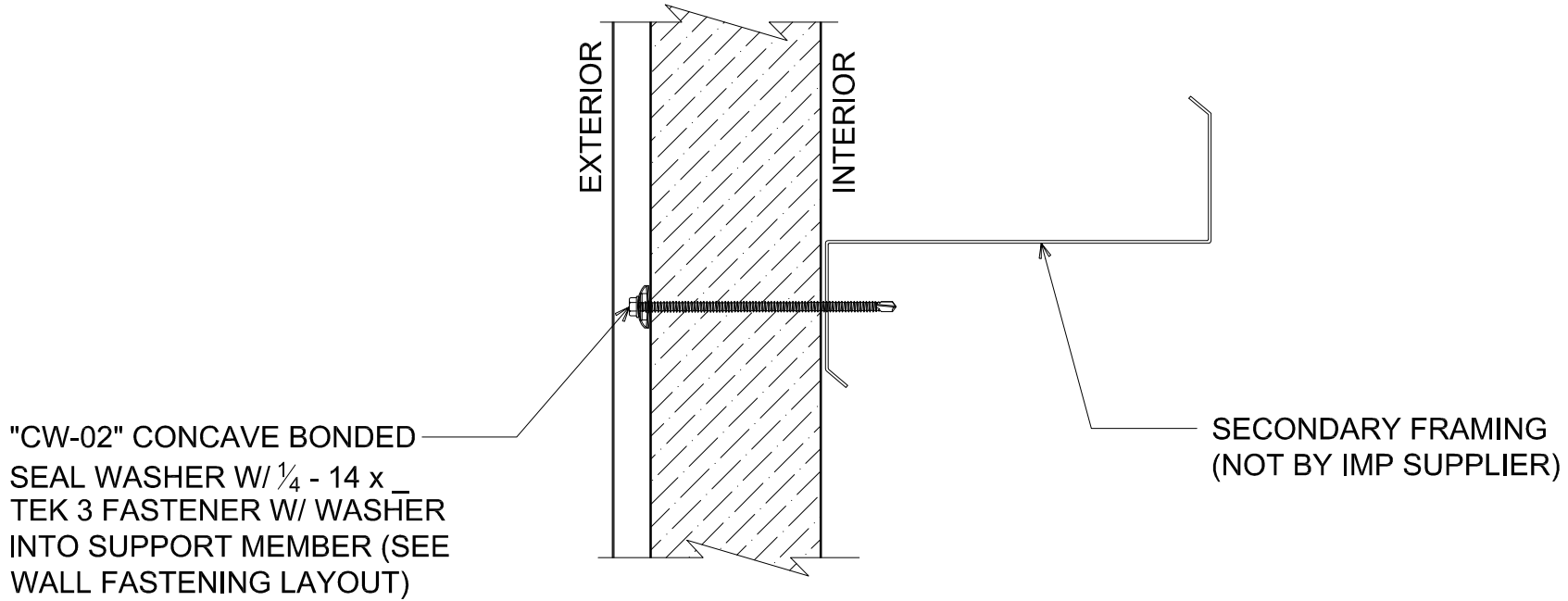

## CW36 INTERMEDIATE WALL FASTENING

(SECTION VIEW)

DETAIL:

### INTERMEDIATE WALL FASTENING

APPLICATION:  
CW36 WALL, COMMERCIAL & INDUSTRIAL

AWIP DETAIL NUMBER:

CWW-AI-IW-001

929 ALDRIDGE ROAD  
VACAVILLE, CA 95688  
TEL: (707) 359-2280  
FAX: (707) 359-2286  
WWW.AWIPANELS.COM

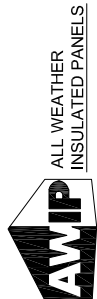

DATE:  
03/08/19

DRAWN BY:  
MMF

SHEET:  
1  
OF  
1