

HR_ INSIDE CLOSURE STRIP
W/ $\frac{3}{4}$ " x $\frac{3}{32}$ " BUTYL TAPE
SEALANT AT TOP & BOTTOM

"GH-01" GUTTER HANGER AT
INTERIOR HI-RIBS 40" O/C
ATTACH W/ (4) $\frac{1}{4}$ " - 14 x $\frac{7}{8}$ "
STITCH TEKS

$\frac{1}{4}$ " - 14 x $\frac{7}{8}$ " STITCH
TEKS 6" O/C

"GT-__" GUTTER TRIM

"BB-01" BIRD BLOCK W/
 $\frac{1}{4}$ " - 14 x $\frac{7}{8}$ " STITCH TEK 12" O/C

"WC-01" PANEL CLIP W/
() $\frac{1}{4}$ " - 14 x _ TEK 3 FASTENERS
W/O WASHER AT PANEL JOINT

BUTYL SEALANT AT
VERTICAL JOINT

FIELD-FILL W/ COMPRESSIBLE
INSULATION
(NOT BY IMP SUPPLIER)

(3) $\frac{1}{4}$ " - 14 x _ TEK 3 FASTENERS
W/ WASHER, PER PANEL
(SPACED EVENLY)

BUTYL TAPE SEALANT

BUTYL TAPE SEALANT (MARRY
TO VERTICAL SEALANT)

EAVE STRUT
(NOT BY IMP SUPPLIER)

EAVE W/ GUTTER

(SECTION VIEW)

NOTE: FIELD-REMOVE FOAM
& LINER AT CUTBACK.

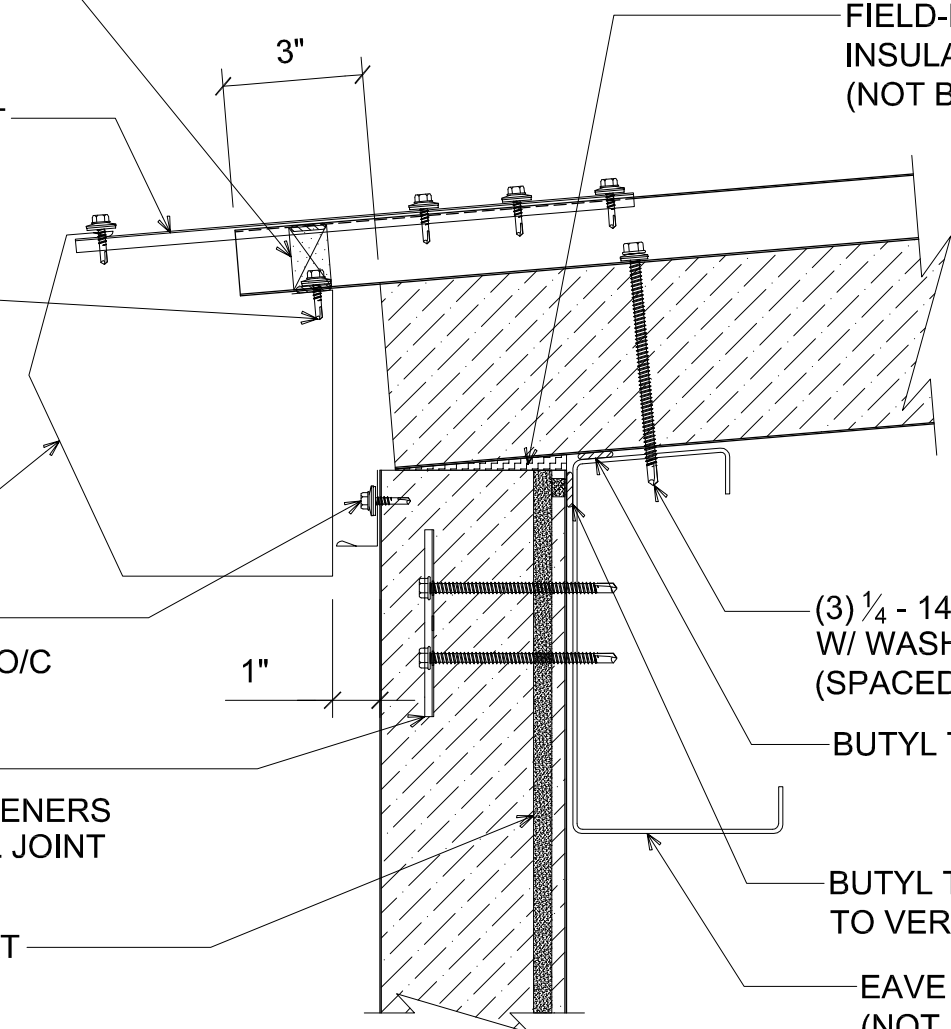

DETAIL: **EAVE WITH GUTTER**
APPLICATION: HR ROOF, COMMERCIAL & INDUSTRIAL
AWIP DETAIL NUMBER: HRR-ACH-EG-001

929 ALDRIDGE ROAD
VACAVILLE, CA 95688
TEL: (707) 359-2280
FAX: (707) 359-2286
WWW.AWIPANELS.COM

