

FILL GAP CONTINUOUSLY WITH TWO-PART FOAMED-IN-PLACE URETHANE; FOR DRY, MILD CLIMATES COMPRESSIBLE INSULATION MAY BE USED (NOT BY IMP SUPPLIER)

¼ -14 x 0.88" HWH DP1 6" O/C

"OR-01" OUTSIDE RIDGE

½"

"HRC- " METAL CLOSURE SET IN 1" x ¾" BUTYL TAPE SEALANT AT TOP AND BOTTOM; REFER TO SHEET \_\_ FOR FASTENING INFORMATION

NOTE: BARE HRC- PROVIDED FOR PROJECTS WITH ROOF SLOPE ≤ 1:12 AND EAVE HEIGHT ≥ 20'.

HR\_ OUTSIDE CLOSURE STRIP SET IN 1" x ¾" BUTYL TAPE SEALANT AT TOP AND BOTTOM

BUTYL TAPE SEALANT

"IR-01" INSIDE RIDGE W/ 10. x 0.75" PPH DP3 12" O/C

SECONDARY FRAMING BY OTHERS (NOT BY IMP SUPPLIER)

"SW-01" SADDLE WASHER W/ ¼ - 14 x \_ HWH DP3 W/ WASHER SPACED \_ O/C (PILOT HOLE RECOMMENDED)

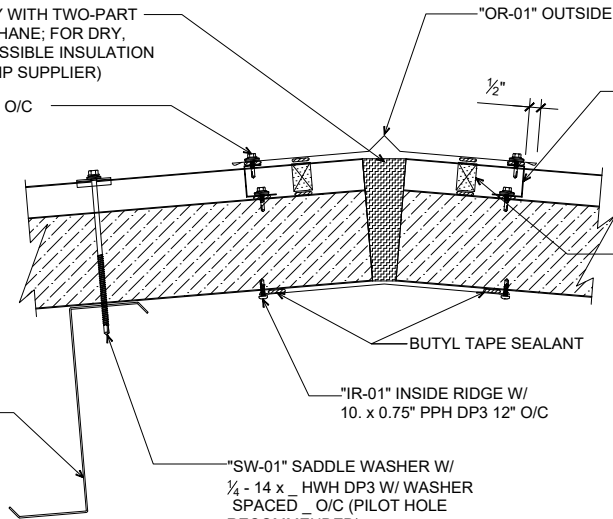

## # RIDGE APEX

(SECTION VIEW)



DETAIL:

## RIDGE APEX

APPLICATION:

HR ROOF, COMMERCIAL & INDUSTRIAL

AWIP DETAIL NUMBER:

HRR-ACHRA-001

DATE:

11/02/23

DRAWN BY:

MMF

SHEET:

1

OF 1

929 ALDRIDGE ROAD  
VACAVILLE, CA 95688  
TEL: (707) 359-2280  
FAX: (707) 359-2286  
WWW.AWIPANELS.COM

**All Weather**  
Insulated Panels

