

FILL GAP CONTINUOUSLY WITH TWO-PART FOAM-IN-PLACE URETHANE (NOT BY IMP SUPPLIER)

"RF-1H" RAKE FASCIA

PEEL & STICK BITUMEN MEMBRANE

"CT-05" CAP TRIM

POP RIVET 12" O/C

"WC-01" PANEL CLIP W/ (\square) $\frac{1}{4}$ - 14 x \square HWH DP3 W/O WASHER AT PANEL JOINT

BUTYL SEALANT AT VERTICAL JOINT

$\frac{1}{4}$ - 14 x 0.88" HWH DP1 12" O/C

1" x $\frac{3}{16}$ " BUTYL TAPE SEALANT

(\square) $\frac{1}{4}$ - 14 x \square HWH DP3 W/ WASHER AT EACH PURLIN

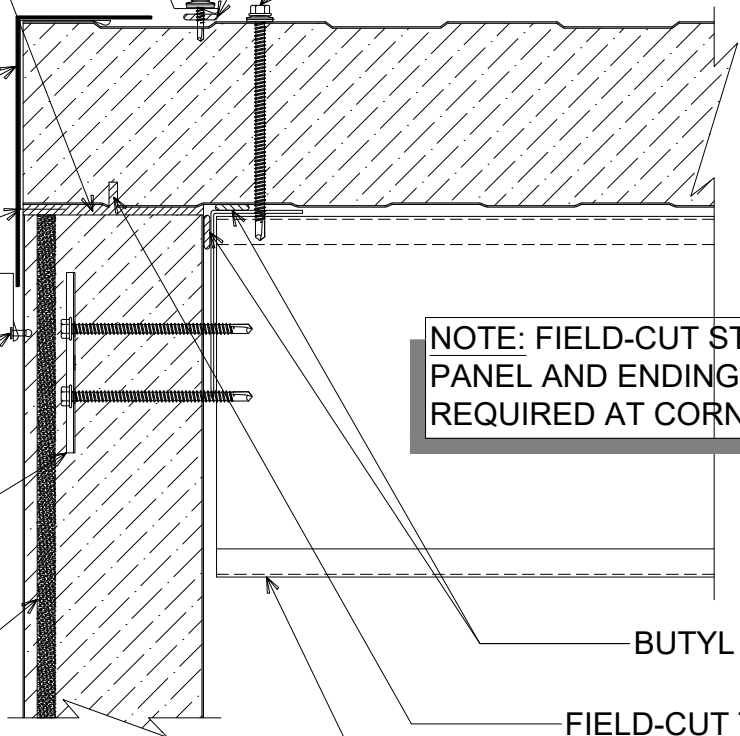

NOTE: FIELD-CUT STARTING ROOF PANEL AND ENDING ROOF PANEL AS REQUIRED AT CORNER TRANSITION(S).

RAKE FASCIA

(SECTION VIEW)

DETAIL: RAKE FASCIA	DATE: 10/04/23	SHEET: 1	OF 1
	APPLICATION: HR ROOF, COLD-STORAGE	DRAWN BY: MMF	

929 ALDRIDGE ROAD
VACAVILLE, CA 95688
TEL: (707) 359-2280
FAX: (707) 359-2286
WWW.AWIPANELS.COM

All Weather
Insulated Panels

AWIP