

1/4 - 14 x 0.88" HWH DP1 2 1/2" O/C

FILL VOIDS AT HIGH-RIB OVERLAP COMPLETELY WITH SEALANT (NOT BY IMP SUPPLIER)

NOTE: BUTYL SEALANT AND BUTYL TAPE TO RUN ACROSS FULL WIDTH OF PANELS; NOT SHOWN AT HIGH RIBS FOR CLARITY.

(1) ROW OF 1" x 3/16" BUTYL TAPE SEALANT

FIELD-APPLIED 3/8" BEAD OF NON-SKINNING BUTYL SEALANT

"JC-01" JOINT COVER (SET TRIM IN BUTYL SEALANT)

"SW-01" SADDLE WASHER W/ 1/4 - 14 x HWH DP3 W/ WASHER SPACED O/C (PILOT HOLE RECOMMENDED)

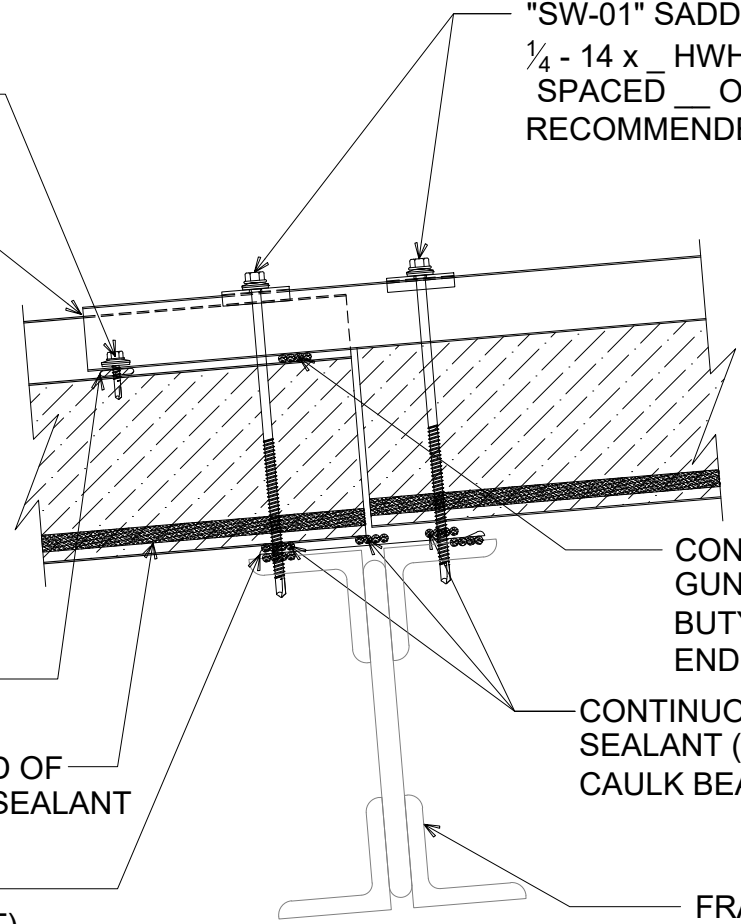

CONTINUOUS 1/2" Ø BEAD OF GUN-GRADE NON-SKINNING BUTYL SEALANT AT PANEL ENDLAP

CONTINUOUS 1/2" Ø BEAD OF BUTYL SEALANT (CONNECT ENDS OF CAULK BEADS TO CLOSE AND BOX)

FRAMING BY OTHERS (NOT BY IMP SUPPLIER)

NOTE: REFER TO SECTION 13.6 ON THE HR3 & HR5 INSULATED ROOF PANELS GENERAL INSTALLATION GUIDE FOR ADDITIONAL INFORMATION.

HR ROOF PANEL ENDLAP

(SECTION VIEW)

DETAIL: ENDLAP

929 ALDRIDGE ROAD
VACAVILLE, CA 95688
TEL: (707) 359-2280
FAX: (707) 359-2286
WWW.AWIPANELS.COM

All Weather
Insulated Panels



APPLICATION: HR ROOF, COMMERCIAL & INDUSTRIAL, COLD-STORAGE, COLD-CLIMATE
AWIP DETAIL NUMBER: HRR-CICISCC-EL-002

DATE: 11/02/23
DRAWN BY: MMF

SHEET: 1 OF 1