

NOTE: INSTALL POLARFAST FASTENERS 1" (MINIMUM) INBOUND OF CUT LINE PRIOR TO FIELD-RIPPING THE PANEL.

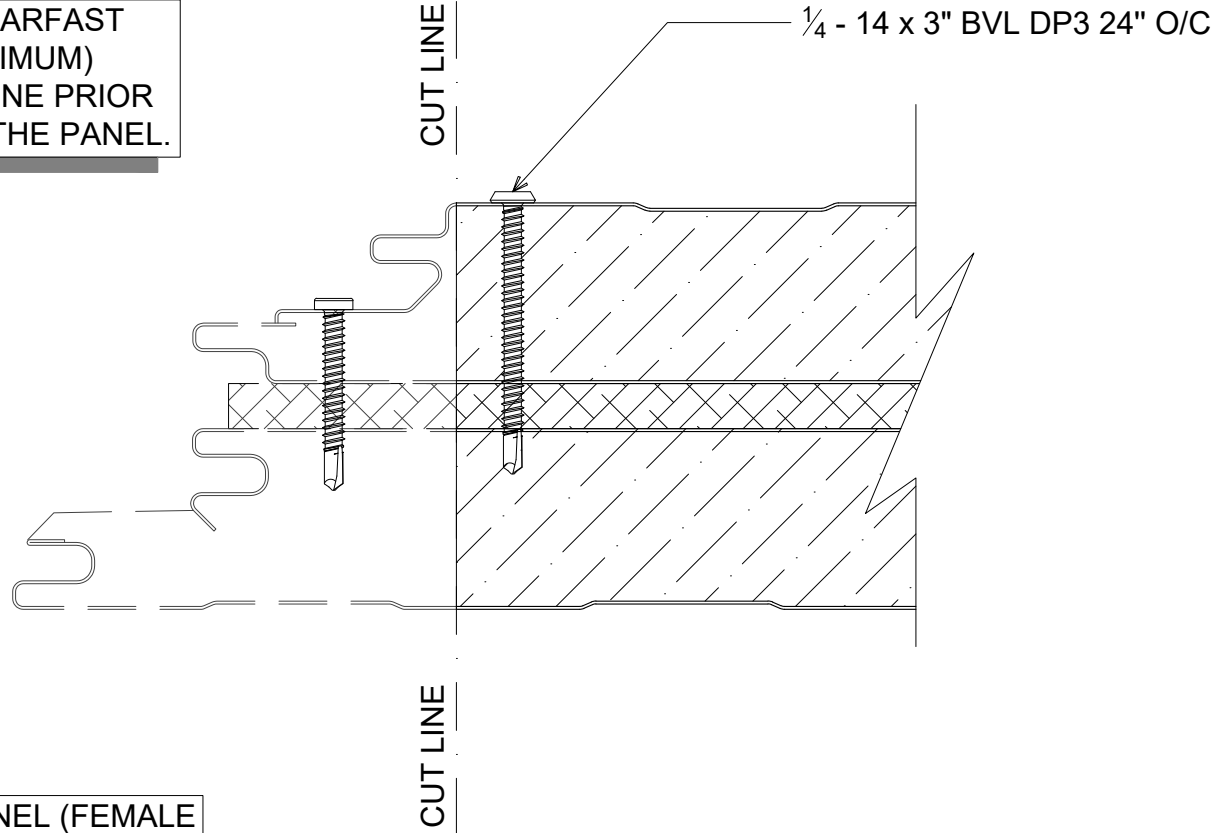

NOTE: LEADING PANEL (FEMALE JOINERY) SHOWN, FASTENING APPLIES TO ENDING PANEL (MALE JOINERY) AS WELL.

STARTING / ENDING PANEL (FIELD-RIP DETAIL)

(PLAN VIEW)

DETAIL:

STARTING / ENDING PANEL

APPLICATION: VERTICAL FIRE WALL, COMMERCIAL & INDUSTRIAL, COLD-CLIMATE

AWIP DETAIL NUMBER:

FWW-CICC-SE-001

DATE:

11/02/23

DRAWN BY:

MMF

SHEET:

1

OF 1

929 ALDRIDGE ROAD
VACAVILLE, CA 95688
TEL: (707) 359-2280
FAX: (707) 359-2286
WWW.AWIPANELS.COM

