

"BC-02" 20 GA CHANNEL CAP W/
#14 - 13 x 1½" TRUSS HEAD TEK
FASTENERS 12" O/C. W/ BUTYL
SEALANT AT FLANGES (MARRY TO
VERTICAL SEALANT)

NOTE: REFER TO DETAIL _E FOR
EDGE METAL ASSEMBLY
INFORMATION.

NOTE: BUTYL SEALANT AT WALL
JOINERY NOT SHOWN FOR CLARITY.
ENSURE ALL SEALANTS MARRY TO
CREATE A THERMAL ENVELOPE.

FILL VOID WITH ONE-PART
EXPANDING FOAM SEALANT

CONTINUOUS THERMAL
CUT FOR COLD STORAGE
APPLICATIONS

"WC-01" PANEL CLIP W/
() ¼ - 14 x _ TEK 3 FASTENERS
W/O WASHER AT PANEL JOINT

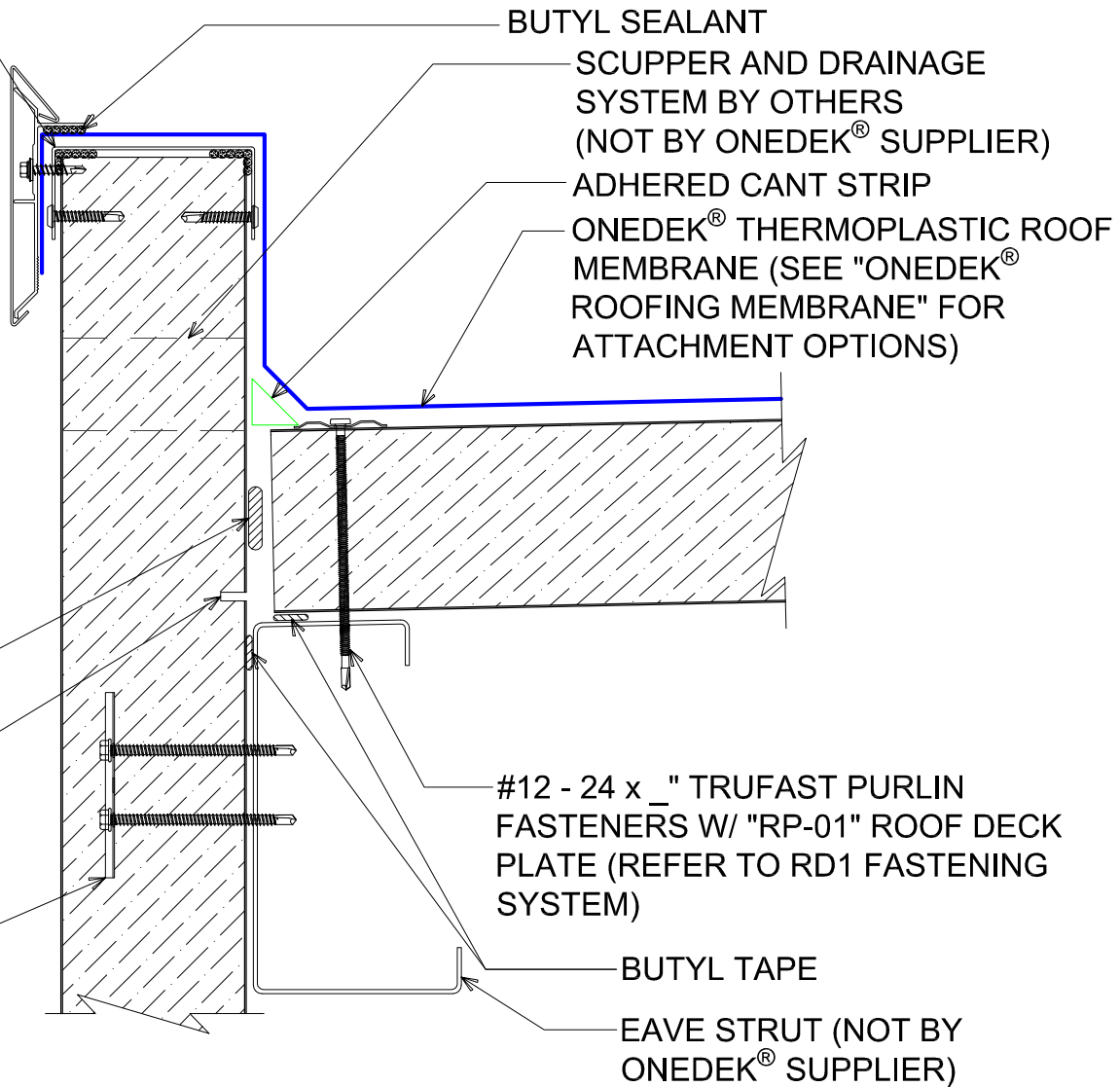

BUTYL SEALANT

SCUPPER AND DRAINAGE
SYSTEM BY OTHERS
(NOT BY ONEDEK® SUPPLIER)

ADHERED CANT STRIP

ONEDEK® THERMOPLASTIC ROOF
MEMBRANE (SEE "ONEDEK®
ROOFING MEMBRANE" FOR
ATTACHMENT OPTIONS)

#12 - 24 x _" TRUFAST PURLIN
FASTENERS W/ "RP-01" ROOF DECK
PLATE (REFER TO RD1 FASTENING
SYSTEM)

BUTYL TAPE

EAVE STRUT (NOT BY
ONEDEK® SUPPLIER)

PARAPET W/ EDGE METAL (EAVE)

(SECTION VIEW)

DETAIL:

PARAPET W/ EDGE METAL (EAVE)

929 ALDRIDGE ROAD
VACAVILLE, CA 95688
TEL: (707) 359-2280
FAX: (707) 359-2286
WWW.AWIPANELS.COM

All Weather
Insulated Panels



APPLICATION:
RD1 ROOF DECK, COMMERCIAL & INDUSTRIAL, COLD-STORAGE

AWIP DETAIL NUMBER:
RDR-CJCS-EW-003

DATE:
08/09/22

SHEET:

DRAWN BY:
MMF

1 OF 1

"BC-02" 20 GA CHANNEL CAP W/
 #14 - 13 x 1½" TRUSS HEAD TEK
 FASTENERS 12" O/C. W/ BUTYL
 SEALANT AT FLANGES (MARRY TO
 VERTICAL SEALANT)

#12-14 x 1¼" HWH/BD TEK 2
 STAINLESS STEEL FASTENERS
 12" O/C

AF-55 FASCIA COVER (12'-0"
 LENGTHS)

ANCHOR BAR EXTRUDED

BUTYL SEALANT

ONEDEK® THERMOPLASTIC ROOF
 MEMBRANE (SEE "ONEDEK®
 ROOFING MEMBRANE" FOR
 ATTACHMENT OPTIONS)

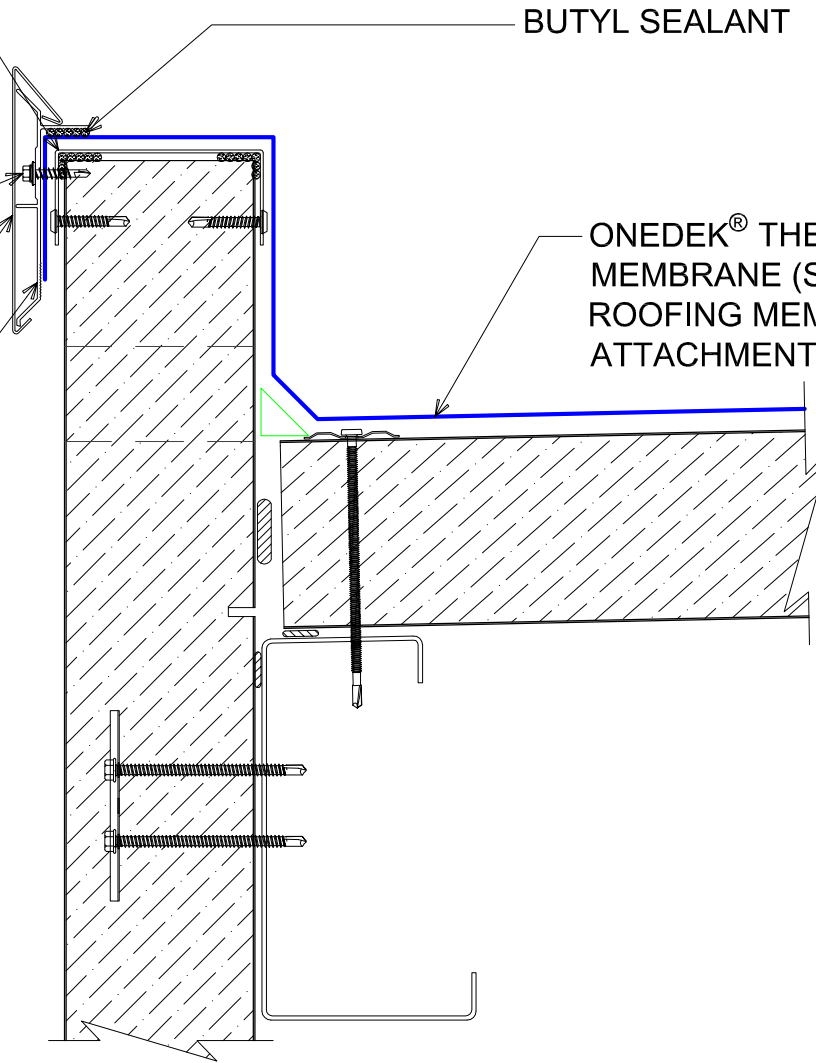

#E PARAPET W/ EDGE METAL (EAVE)

(SECTION VIEW)

DETAIL: **PARAPET W/ EDGE METAL (EAVE), AF-55**

DATE:	08/09/22	SHEET:	1	OF	1
APPLICATION:	RD1 ROOF DECK, COMMERCIAL & INDUSTRIAL, COLD-STORAGE	DRAWN BY:	MMF		
AW/P DETAIL NUMBER:	RDR-CICS-EW-003				

929 ALDRIDGE ROAD
 VACAVILLE, CA 95688
 TEL: (707) 359-2280
 FAX: (707) 359-2286
 WWW.AWIPANELS.COM



"BC-02" 20 GA CHANNEL CAP W/
 #14 - 13 x 1 1/2" TRUSS HEAD TEK
 FASTENERS 12" O/C. W/ BUTYL
 SEALANT AT FLANGES (MARRY TO
 VERTICAL SEALANT)

#12-14 x 1 1/4" HWH/BD TEK 2
 STAINLESS STEEL FASTENERS
 12" O/C

AF-70 FASCIA COVER (12'-0"
 LENGTHS)

ANCHOR BAR EXTRUDED

BUTYL SEALANT

ONEDEK® THERMOPLASTIC ROOF
 MEMBRANE (SEE "ONEDEK®
 ROOFING MEMBRANE" FOR
 ATTACHMENT OPTIONS)

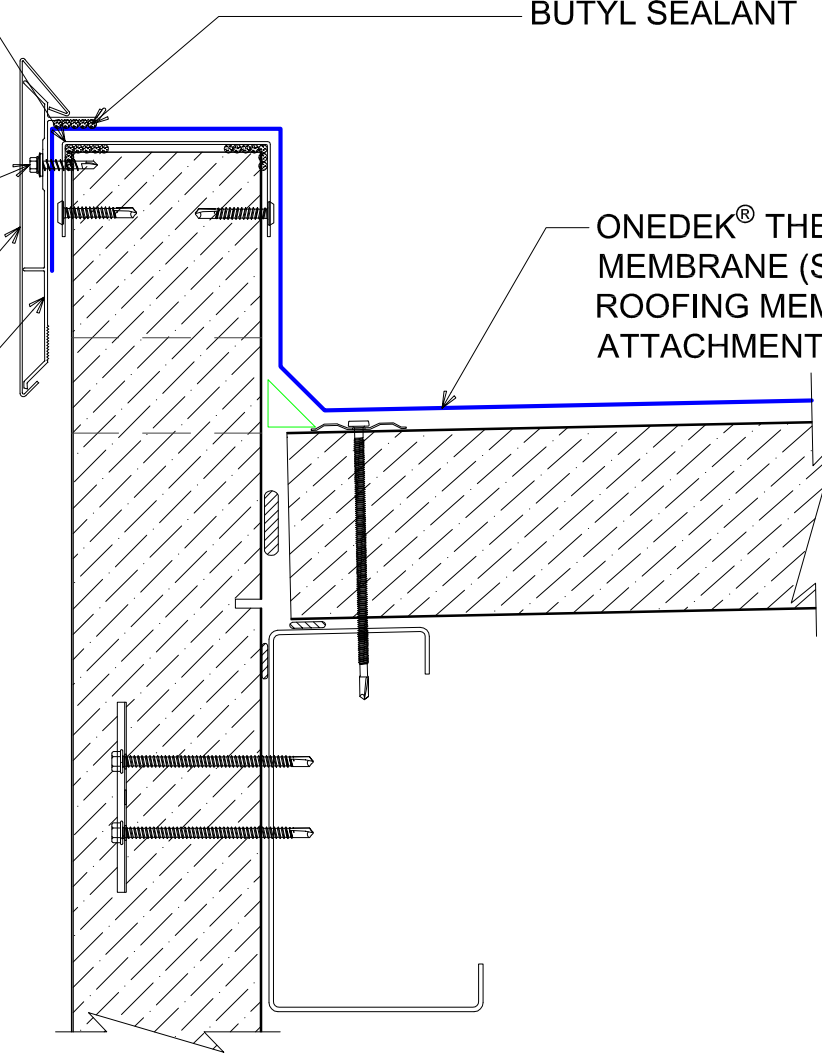

#E PARAPET W/ EDGE METAL (EAVE)

(SECTION VIEW)

DETAIL:

PARAPET W/ EDGE METAL (EAVE), AF-70

APPLICATION:
 RD1 ROOF DECK, COMMERCIAL & INDUSTRIAL, COLD-STORAGE
 AW/P DETAIL NUMBER:
 RDR-CICS-EW-003

DATE:
 08/09/22
 DRAWN BY:
 MMF

SHEET:
1
 OF
1

929 ALDRIDGE ROAD
 VACAVILLE, CA 95688
 TEL: (707) 359-2280
 FAX: (707) 359-2286
 WWW.AWIPANELS.COM

