

WOOD NAILER BY OTHERS
(NOT BY ONEDEK® SUPPLIER)

NOTE: REFER TO DETAIL _E FOR
EDGE METAL ASSEMBLY
INFORMATION.

FILL VOID WITH ONE-PART
EXPANDING FOAM SEALANT
(NOT BY ONEDEK® SUPPLIER)

VERIFY

WALL SYSTEM BY OTHERS
(NOT BY ONEDEK® SUPPLIER)

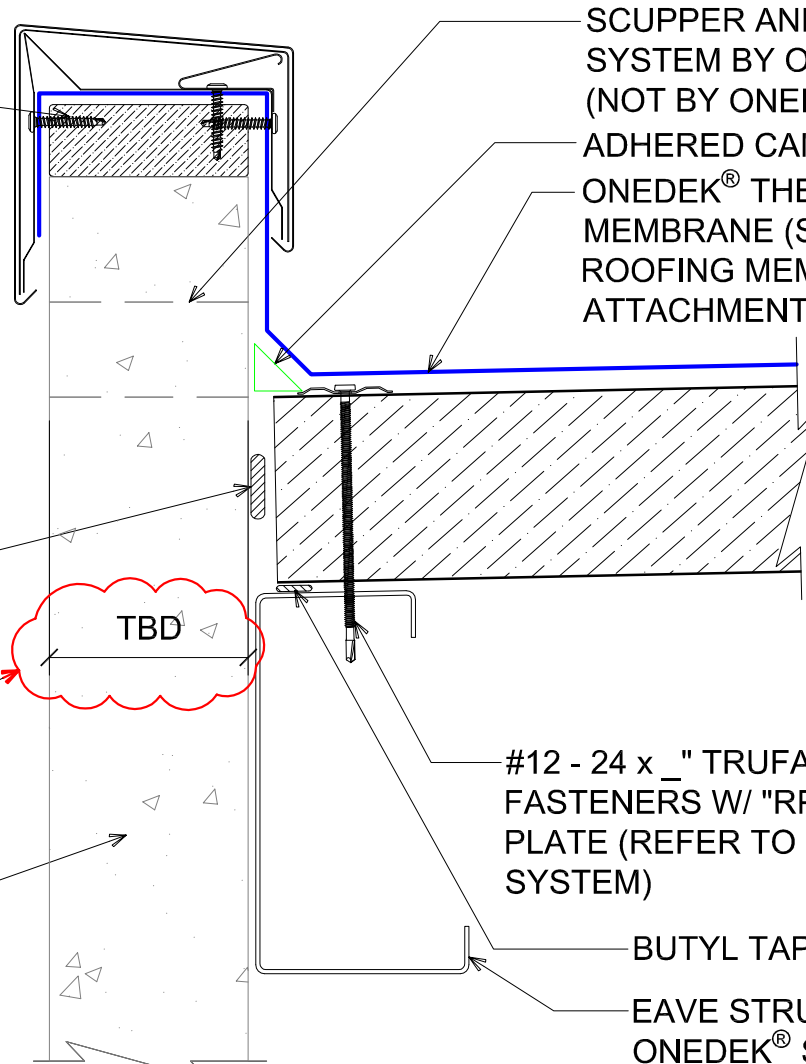

SCUPPER AND DRAINAGE
SYSTEM BY OTHERS
(NOT BY ONEDEK® SUPPLIER)

ADHERED CANT STRIP

ONEDEK® THERMOPLASTIC ROOF
MEMBRANE (SEE "ONEDEK®
ROOFING MEMBRANE" FOR
ATTACHMENT OPTIONS)

#12 - 24 x _" TRUFAST PURLIN
FASTENERS W/ "RP-01" ROOF DECK
PLATE (REFER TO RD1 FASTENING
SYSTEM)

BUTYL TAPE

EAVE STRUT (NOT BY
ONEDEK® SUPPLIER)

BASE FLASHING AT PARAPET W/ METAL COPING (EAVE)

(SECTION VIEW)

DETAIL:

PARAPET W/ METAL COPING (EAVE)

929 ALDRIDGE ROAD
VACAVILLE, CA 95688
TEL: (707) 359-2280
FAX: (707) 359-2286
WWW.AWIPANELS.COM

All Weather
Insulated Panels



APPLICATION:
RD1 ROOF DECK, COMMERCIAL & INDUSTRIAL, COLD-STORAGE
AWIP DETAIL NUMBER:
RDR-CICS-WBO-006

DATE:
08/09/22
DRAWN BY:
MMF

SHEET:
1
OF
1

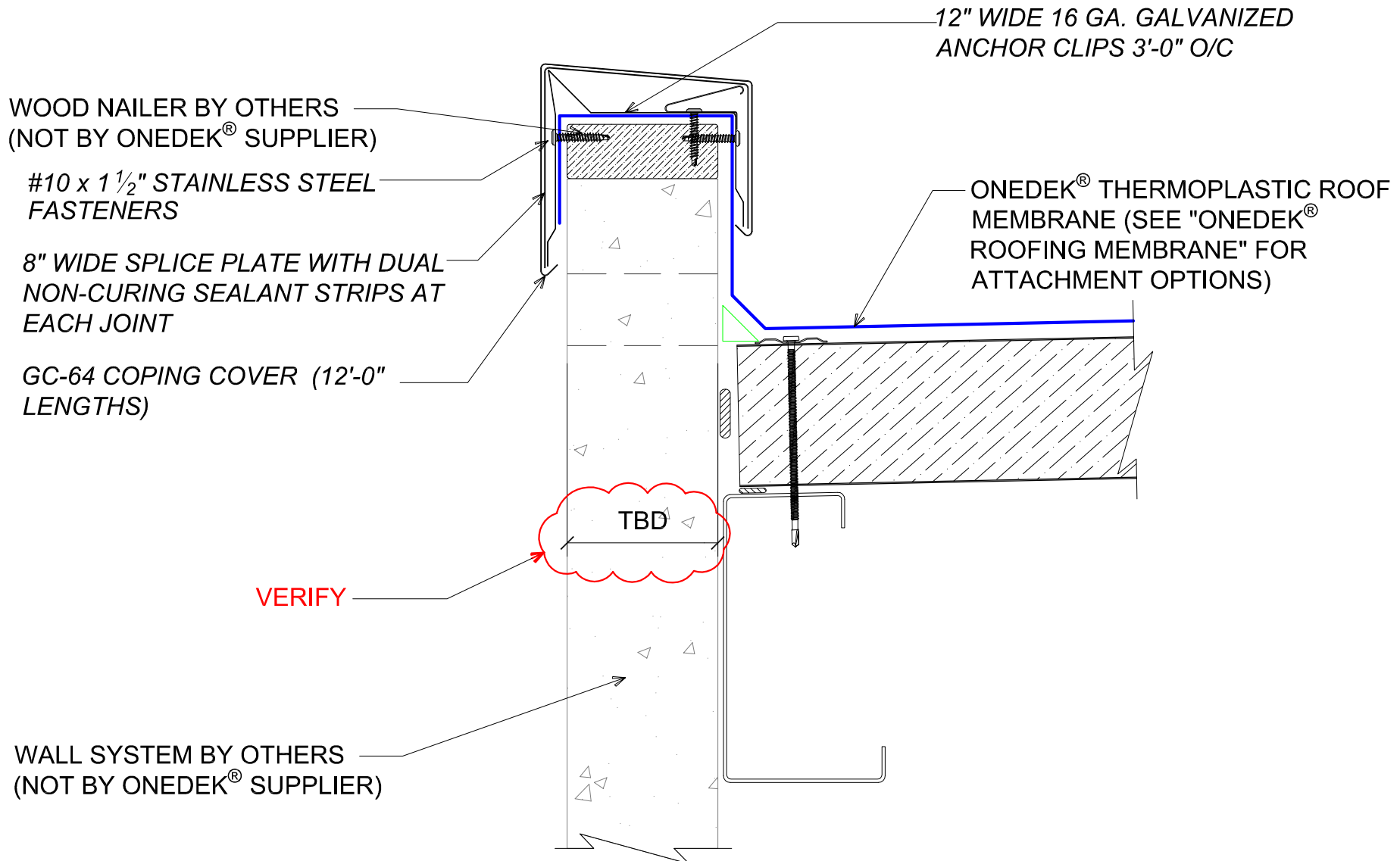

WOOD NAILER BY OTHERS
(NOT BY ONEDEK® SUPPLIER)

#10 x 1 1/2" STAINLESS STEEL
FASTENERS

8" WIDE SPLICE PLATE WITH DUAL
NON-CURING SEALANT STRIPS AT
EACH JOINT

GC-64 COPING COVER (12'-0"
LENGTHS)

12" WIDE 16 GA. GALVANIZED
ANCHOR CLIPS 3'-0" O/C

ONEDEK® THERMOPLASTIC ROOF
MEMBRANE (SEE "ONEDEK®
ROOFING MEMBRANE" FOR
ATTACHMENT OPTIONS)

VERIFY

TBD

WALL SYSTEM BY OTHERS
(NOT BY ONEDEK® SUPPLIER)

#E BASE FLASHING AT PARAPET W/ METAL COPING (EAVE)

(SECTION VIEW)

DETAIL:

PARAPET W/ METAL COPING (EAVE), GC-64

DATE:	08/09/22	SHEET:	1	OF	1
APPLICATION:	RD1 ROOF DECK, COMMERCIAL & INDUSTRIAL, COLD-STORAGE	DRAWN BY:	MMF		
AWIP DETAIL NUMBER:	RDR-CICS-WBO-006				

929 ALDRIDGE ROAD
VACAVILLE, CA 95688
TEL: (707) 359-2280
FAX: (707) 359-2286
WWW.AWIPANELS.COM

