

NOTE: REFER TO DETAIL _E FOR
EDGE METAL ASSEMBLY
INFORMATION.

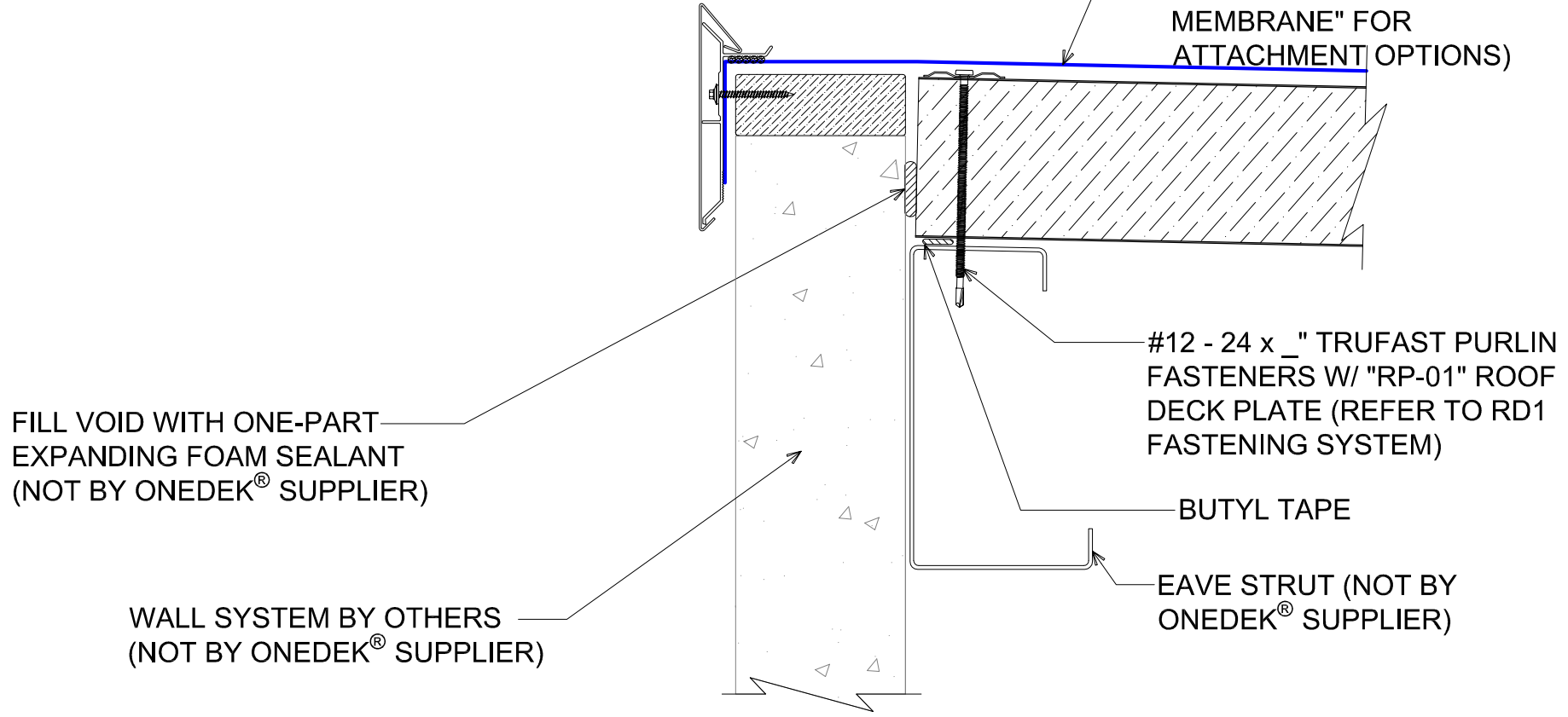

ONEDEK® THERMOPLASTIC
ROOF MEMBRANE (SEE
"ONEDEK® ROOFING
MEMBRANE" FOR
ATTACHMENT OPTIONS)

#12 - 24 x _" TRUFast PURLIN
FASTENERS W/ "RP-01" ROOF
DECK PLATE (REFER TO RD1
FASTENING SYSTEM)

BUTYL TAPE

EAVE STRUT (NOT BY
ONEDEK® SUPPLIER)

FILL VOID WITH ONE-PART
EXPANDING FOAM SEALANT
(NOT BY ONEDEK® SUPPLIER)

WALL SYSTEM BY OTHERS
(NOT BY ONEDEK® SUPPLIER)

PERIMETER EDGE METAL (HIGH EAVE)

(SECTION VIEW)

DETAIL:
PERIMETER EDGE METAL (HIGH EAVE)

DATE:	08/09/22	SHEET:	1
DRAWN BY:	MMF	OF	1
APPLICATION:	RD1 ROOF DECK, COMMERCIAL & INDUSTRIAL, COLD-STORAGE		
AWIP DETAIL NUMBER:	RDR-CJCS-WBO-008		

929 ALDRIDGE ROAD
VACAVILLE, CA 95688
TEL: (707) 359-2280
FAX: (707) 359-2286
WWW.AWIPANELS.COM



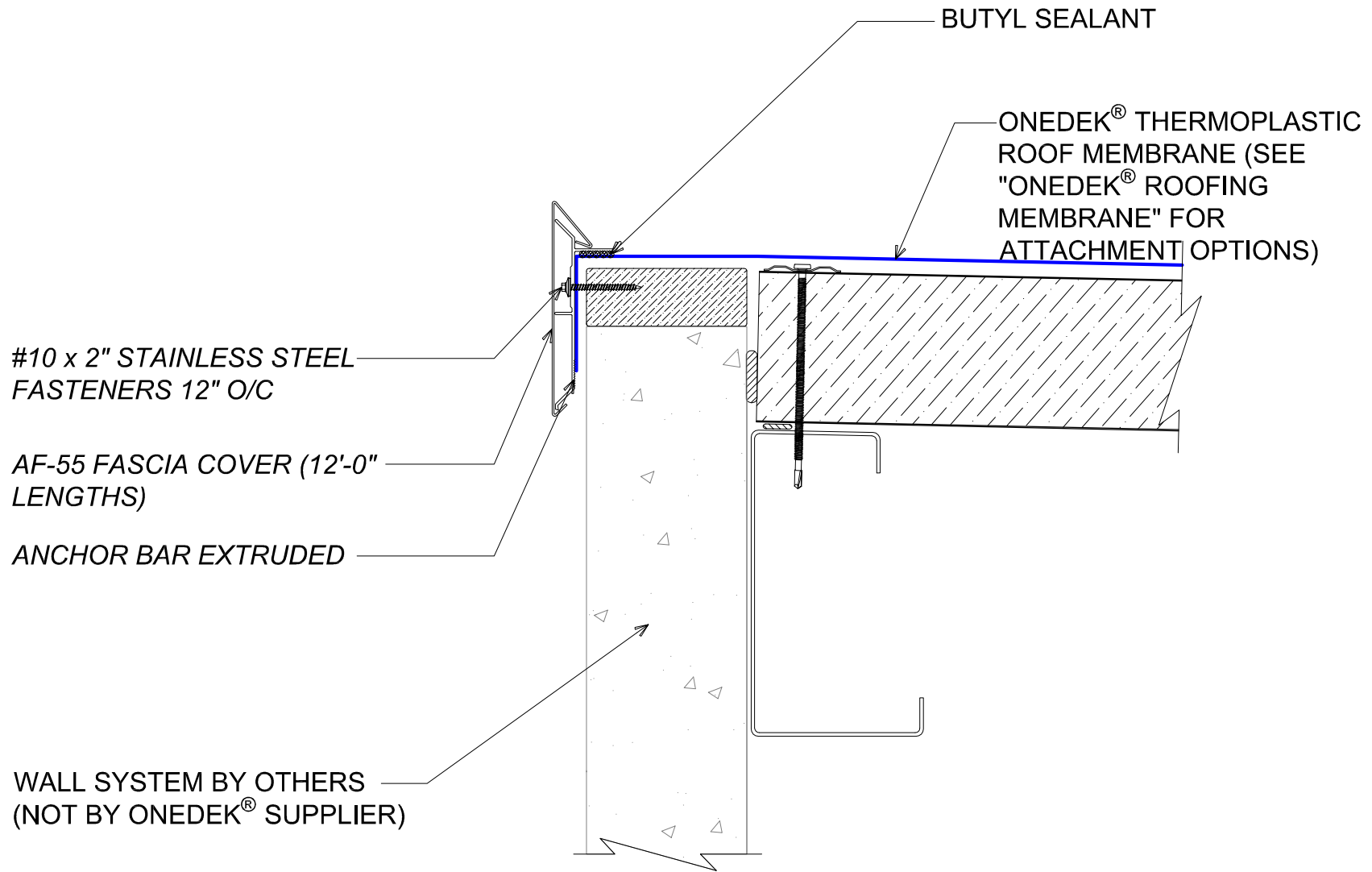

#E PERIMETER EDGE METAL (HIGH EAVE)

(SECTION VIEW)

DETAIL:

PERIMETER EDGE METAL (HIGH EAVE), AF-55

APPLICATION:

RD1 ROOF DECK, COMMERCIAL & INDUSTRIAL, COLD-STORAGE

AWIP DETAIL NUMBER:

RDR-CICS-WBO-008

DATE:

08/09/22

DRAWN BY:

MMF

SHEET:

1

OF

1

929 ALDRIDGE ROAD
VACAVILLE, CA 95688
TEL: (707) 359-2280
FAX: (707) 359-2286
WWW.AWIPANELS.COM



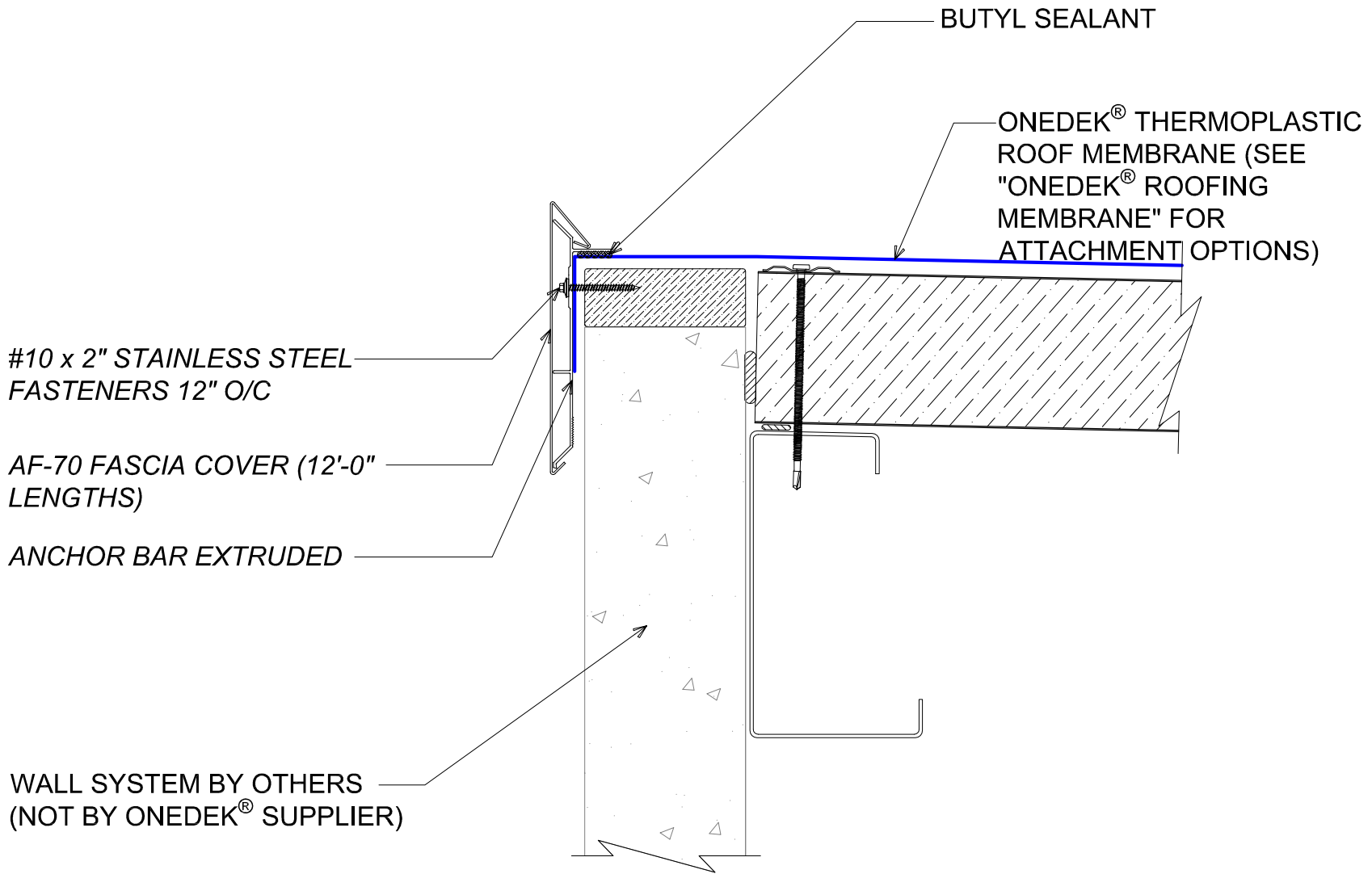

#E PERIMETER EDGE METAL (HIGH EAVE)

(SECTION VIEW)

DETAIL:

PERIMETER EDGE METAL (HIGH EAVE), AF-70

APPLICATION:
RD1 ROOF DECK, COMMERCIAL & INDUSTRIAL, COLD-STORAGE
AW/P DETAIL NUMBER:
RDR-CICS-WBO-008

DATE:
08/09/22
DRAWN BY:
MMF

SHEET:
1
OF
1

929 ALDRIDGE ROAD
VACAVILLE, CA 95688
TEL: (707) 359-2280
FAX: (707) 359-2286
WWW.AWIPANELS.COM

