

WOOD NAILER BY OTHERS
(NOT BY ONEDEK® SUPPLIER)
#15 - 13 x 1 1/4" TRUSS HEAD
FASTENERS W/ "RP-02" BARBED
MEMBRANE PLATE 6" O/C

NOTE: REFER TO DETAIL _E FOR
EDGE METAL ASSEMBLY
INFORMATION.

VERIFY

FILL VOID WITH ONE-PART
EXPANDING FOAM SEALANT
(NOT BY ONEDEK® SUPPLIER)

WALL SYSTEM BY OTHERS
(NOT BY ONEDEK® SUPPLIER)

ADHERED ONEDEK® FLASHING

1 1/2"

MIN. WELD
(CONTINUOUS)

ONEDEK® THERMOPLASTIC ROOF
MEMBRANE (SEE "ONEDEK®
ROOFING MEMBRANE" FOR
ATTACHMENT OPTIONS)

TBD

#12 - 24 x _" TRUFAST PURLIN
FASTENERS W/ "RP-01" ROOF
DECK PLATE _" O/C

BUTYL TAPE

SECONDARY
FRAMING & RAKE
ANGLE BY OTHERS
(NOT BY ONEDEK®
SUPPLIER)

BASE FLASHING AT PARAPET W/ METAL COPING (RAKE)

(SECTION VIEW)



DETAIL: **PARAPET W/ METAL COPING (RAKE)**

APPLICATION: RD1 ROOF DECK, COMMERCIAL & INDUSTRIAL, COLD-STORAGE
AWIP DETAIL NUMBER: RDR-CICS-WBO-002

929 ALDRIDGE ROAD
VACAVILLE, CA 95688
TEL: (707) 359-2280
FAX: (707) 359-2286
WWW.AWIPANELS.COM

All Weather
Insulated Panels
AWIP

DATE: 02/07/23
DRAWN BY: MMF
SHEET: 1 OF 1

WOOD NAILER BY OTHERS
(NOT BY ONEDEK® SUPPLIER)

#10 x 1 1/2" STAINLESS STEEL
FASTENERS

8" WIDE SPLICE PLATE WITH DUAL
NON-CURING SEALANT STRIPS AT
EACH JOINT

GC-64 COPING COVER (12'-0"
LENGTHS)

12" WIDE 16 GA. GALVANIZED
ANCHOR CLIPS 3'-0" O/C

VERIFY

WALL SYSTEM BY OTHERS
(NOT BY ONEDEK® SUPPLIER)

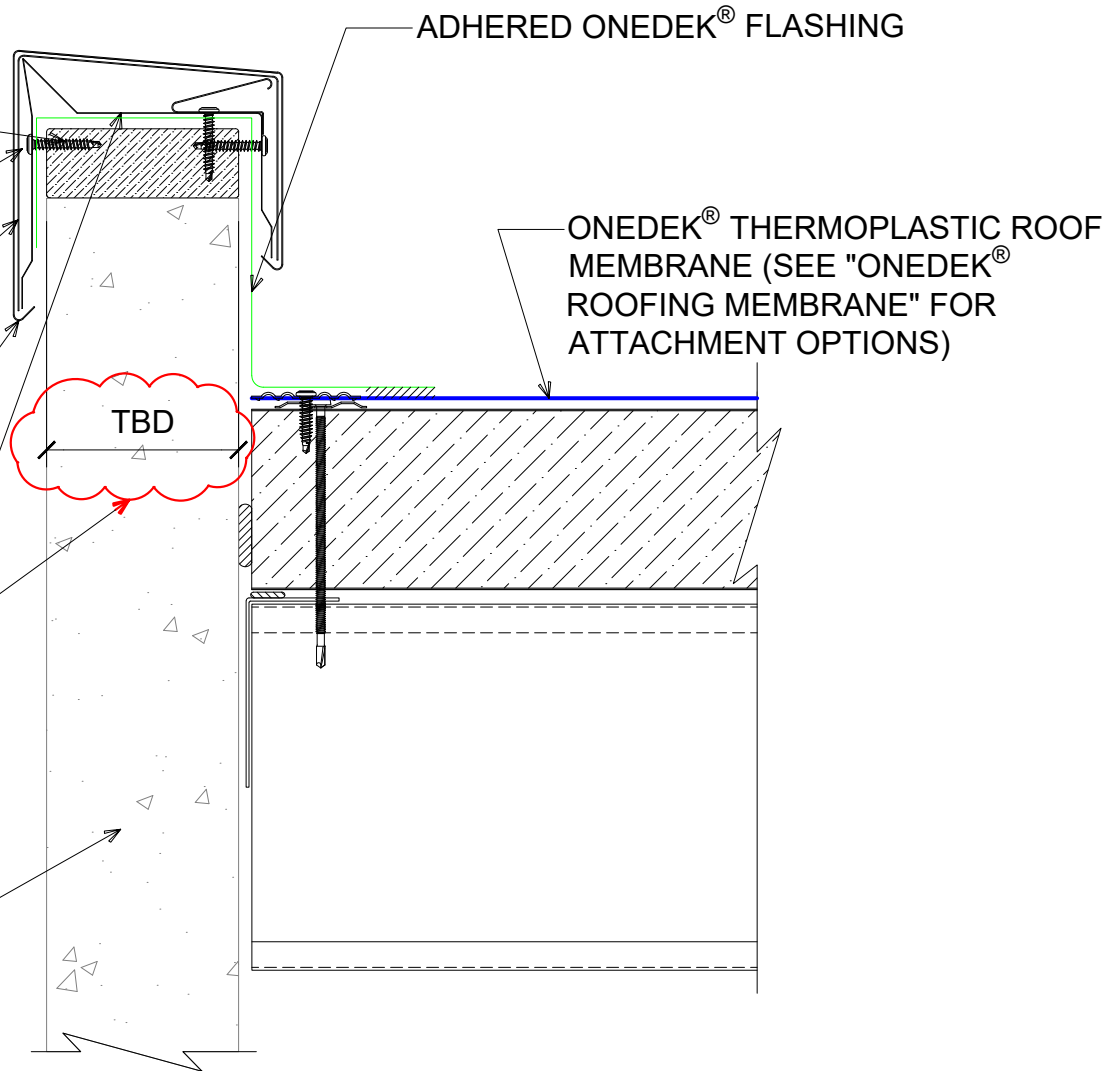

#E BASE FLASHING AT PARAPET W/ METAL COPING (RAKE)

(SECTION VIEW)

DETAIL:

PARAPET W/ METAL COPING (RAKE), GC-64

APPLICATION:
RD1 ROOF DECK, COMMERCIAL & INDUSTRIAL, COLD-STORAGE
AWIP DETAIL NUMBER:
RDR-CICS-WBO-002

DATE:
02/07/23

DRAWN BY:
MMF

SHEET:

1 OF 1

929 ALDRIDGE ROAD
VACAVILLE, CA 95688
TEL: (707) 359-2280
FAX: (707) 359-2286
WWW.AWIPANELS.COM

All Weather
Insulated Panels

