

"BC-02" 20 GA CHANNEL CAP W/  
14. - 13 x 1.5" TRU DP1 12" O/C. W/  
BUTYL SEALANT AT FLANGES (MARRY  
TO VERTICAL SEALANT)

NOTE: REFER TO DETAIL \_E FOR  
EDGE METAL ASSEMBLY  
INFORMATION.

ADHERED ONEDEK® FLASHING

NOTE: BUTYL SEALANT AT WALL  
JOINERY NOT SHOWN FOR CLARITY.  
ENSURE ALL SEALANTS MARRY TO  
CREATE A THERMAL ENVELOPE.

FILL VOID WITH ONE-PART  
EXPANDING FOAM SEALANT

CONTINUOUS THERMAL  
CUT FOR COLD STORAGE  
APPLICATIONS

"WC-01" PANEL CLIP W/  
( ) 1/4 - 14 x \_ HWH DP3 W/O  
WASHER AT PANEL JOINT

SCUPPER AND DRAINAGE SYSTEM BY  
OTHERS (NOT BY ONEDEK® SUPPLIER)  
1 1/2"

MIN. WELD  
(CONTINUOUS)

ONEDEK® THERMOPLASTIC ROOF  
MEMBRANE (SEE "ONEDEK®  
ROOFING MEMBRANE" FOR  
ATTACHMENT OPTIONS)

15. - 13 x 1.3" TRU DP1 W/ "RP-02"  
BARBED MEMBRANE PLATE 6" O/C

12. - 24 x \_ PNC DP4 W/ "RP-01" ROOF  
DECK PLATE (REFER TO RD1  
FASTENING SYSTEM)

BUTYL TAPE

EAVE STRUT (NOT BY  
ONEDEK® SUPPLIER)

## # PARAPET W/ EDGE METAL (EAVE)

(SECTION VIEW)

DETAIL:

PARAPET W/ EDGE METAL (EAVE)

929 ALDRIDGE ROAD  
VACAVILLE, CA 95688  
TEL: (707) 359-2280  
FAX: (707) 359-2286  
WWW.AWIPANELS.COM

**All Weather**  
Insulated Panels



APPLICATION:  
RD1 ROOF DECK, COMMERCIAL & INDUSTRIAL, COLD-STORAGE  
AWIP DETAIL NUMBER:  
RDR-CICS-EW-003

DATE:  
11/06/23  
DRAWN BY:  
MMF

SHEET:

1 OF 1

"BC-02" 20 GA CHANNEL CAP W/  
14. - 13 x 1.5" TRU DP1 12" O/C. W/  
BUTYL SEALANT AT FLANGES (MARRY  
TO VERTICAL SEALANT)

#14 x 1 1/2" UNIVERSAL  
FASTENER 12" O/C

AF-55 FASCIA COVER (12'-0"  
LENGTHS)

ANCHOR BAR EXTRUDED

ADHERED ONEDEK® FLASHING

BUTYL SEALANT

ONEDEK® THERMOPLASTIC ROOF  
MEMBRANE (SEE "ONEDEK®  
ROOFING MEMBRANE" FOR  
ATTACHMENT OPTIONS)

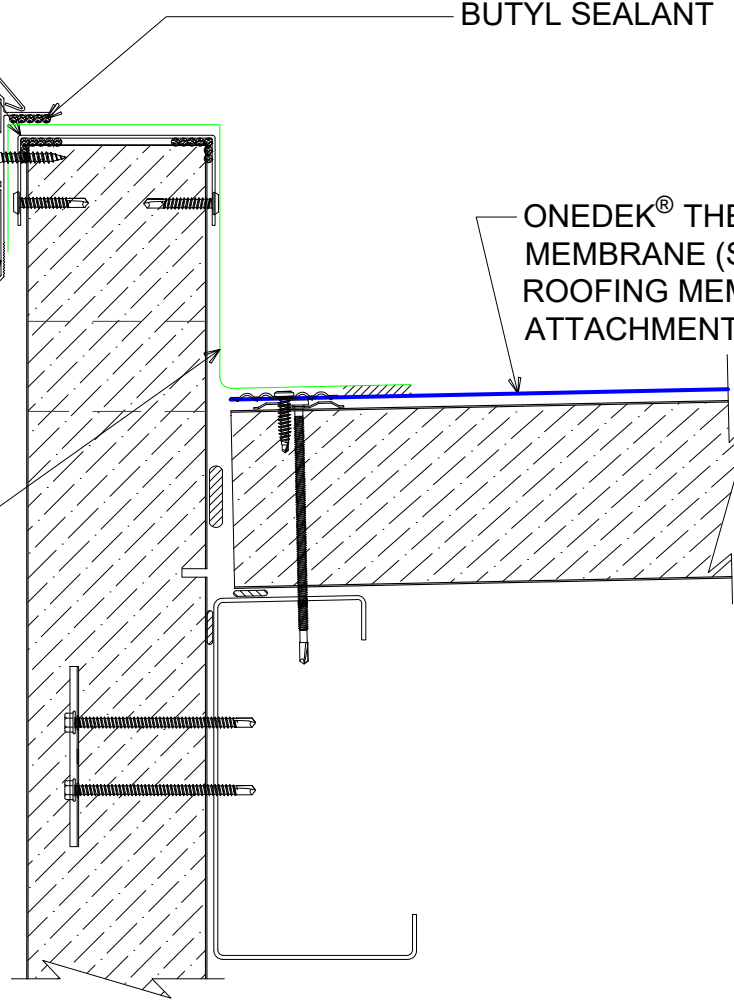

## #E PARAPET W/ EDGE METAL (EAVE)

(SECTION VIEW)

DETAIL:

PARAPET W/ EDGE METAL (EAVE), AF-55

APPLICATION:

RD1 ROOF DECK, COMMERCIAL & INDUSTRIAL, COLD-STORAGE

AWIP DETAIL NUMBER:

RDR-CICS-EW-003

DATE:

11/06/23

DRAWN BY:

MMF

SHEET:

1

OF 1

929 ALDRIDGE ROAD  
VACAVILLE, CA 95688  
TEL: (707) 359-2280  
FAX: (707) 359-2286  
WWW.AWIPANELS.COM

**All Weather**  
Insulated Panels



"BC-02" 20 GA CHANNEL CAP W/  
14. - 13 x 1.5" TRU DP1 12" O/C. W/  
BUTYL SEALANT AT FLANGES  
(MARRY TO VERTICAL SEALANT)

#14 x 1 1/2" UNIVERSAL  
FASTENER 12" O/C

AF-70 FASCIA COVER (12'-0"  
LENGTHS)

ANCHOR BAR EXTRUDED

ADHERED ONEDEK® FLASHING

BUTYL SEALANT

ONEDEK® THERMOPLASTIC ROOF  
MEMBRANE (SEE "ONEDEK®  
ROOFING MEMBRANE" FOR  
ATTACHMENT OPTIONS)

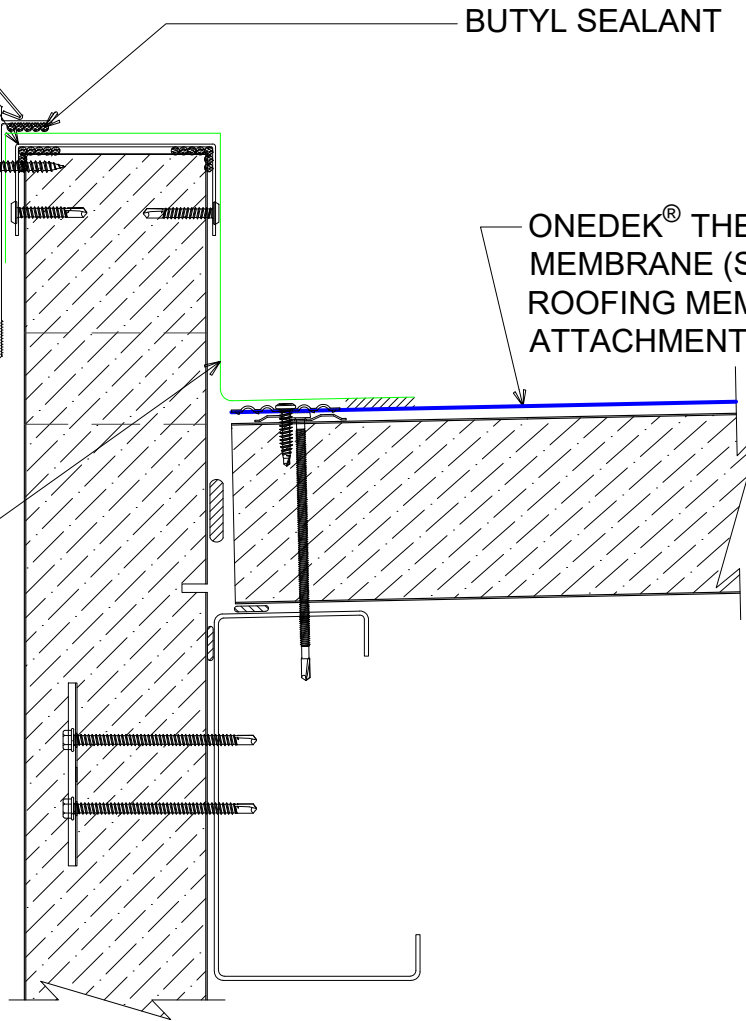

## #E PARAPET W/ EDGE METAL (EAVE)

(SECTION VIEW)

DETAIL:

PARAPET W/ EDGE METAL (EAVE), AF-70

APPLICATION:

RD1 ROOF DECK, COMMERCIAL & INDUSTRIAL, COLD-STORAGE

AWIP DETAIL NUMBER:

RDR-CICS-EW-003

DATE:

11/06/23

DRAWN BY:

MMF

SHEET:

1

OF 1

929 ALDRIDGE ROAD  
VACAVILLE, CA 95688  
TEL: (707) 359-2280  
FAX: (707) 359-2286  
WWW.AWIPANELS.COM

**All Weather**  
Insulated Panels

