

ONEDEK® ROOF MEMBRANE
ADHESIVE

ADHERED/HOT-AIR WELDED
45 MIL FLASHING

ONEDEK® THERMOPLASTIC
ROOF MEMBRANE

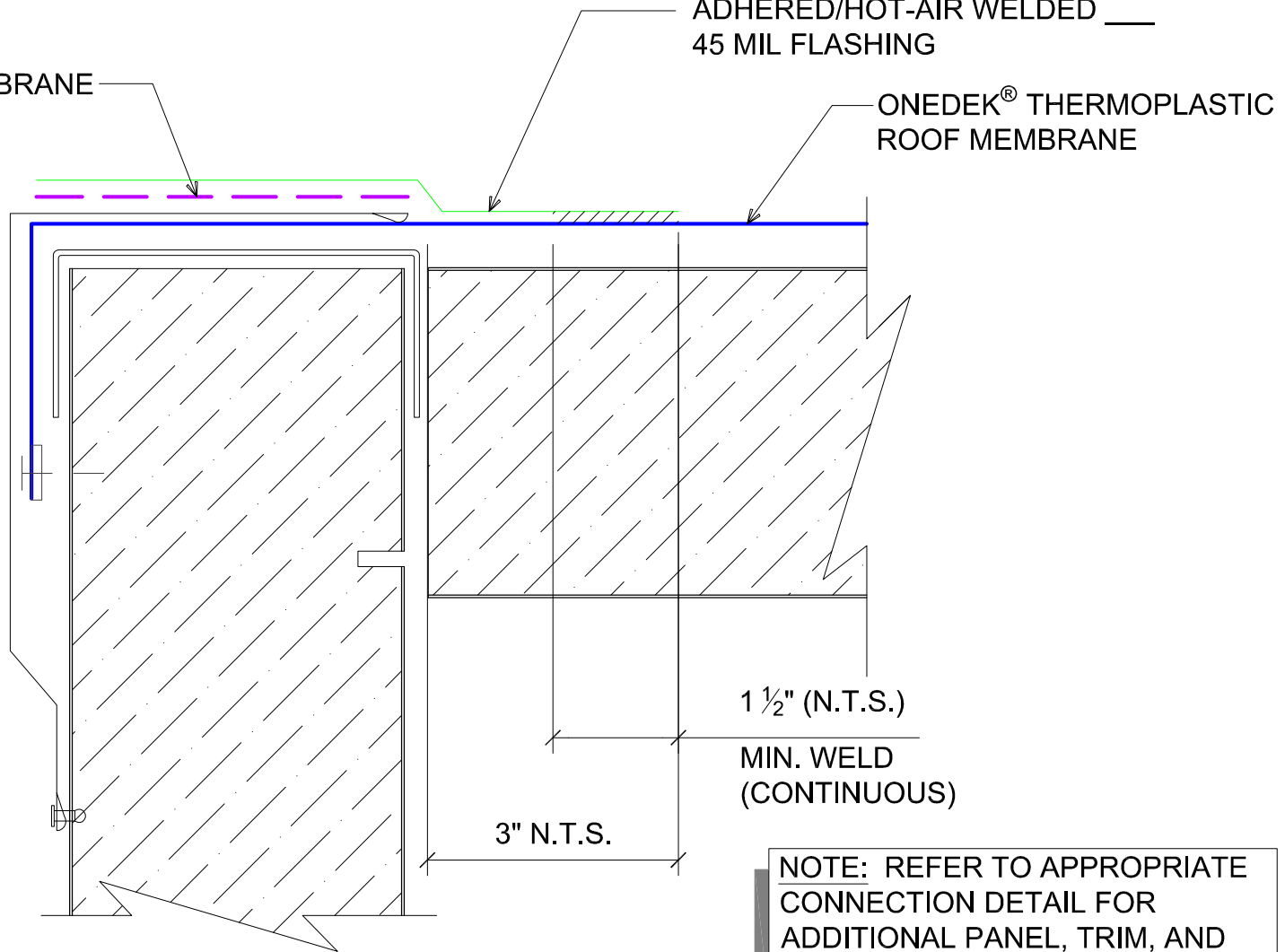

1 1/2" (N.T.S.)

MIN. WELD
(CONTINUOUS)

3" N.T.S.

NOTE: REFER TO APPROPRIATE
CONNECTION DETAIL FOR
ADDITIONAL PANEL, TRIM, AND
ACCESSORIES INFORMATION.

#M 45 MIL FLASHING APPLICATION

(SECTION VIEW)

DETAIL:

45 MIL FLASHING APPLICATION

APPLICATION:
RD1 ROOF DECK, COMMERCIAL & INDUSTRIAL, COLD-STORAGE
AWIP DETAIL NUMBER:
RDR-CICS-MA-001

DATE:

11/03/21

DRAWN BY:

MMF

SHEET:

1

OF
1

929 ALDRIDGE ROAD
VACAVILLE, CA 95688
TEL: (707) 359-2280
FAX: (707) 359-2286
WWW.AWIPANELS.COM

